



0 TO 4  
MONTHS YEARS

**LIFETIME WARRANTY**  
SEE INSIDE FOR MORE DETAILS

# CONVERTIBLE CAR SEAT

SEAT BELT  
COMPATIBLE

MODEL: **CS3013**



**FORWARD FACING**

**REARWARD FACING**

## INSTRUCTION MANUAL

Infant to Child Convertible Car Seat  
CS3013 Type A2/B  
0 Months to 4 Years\*

**(Rearward Facing)** Suitable for children from birth to approximately 12 months\* of age.

**(Forward Facing)** Suitable for children from 6 Months to approximately 4 years\* of age.

IMPORTANT: KEEP THIS BOOKLET IN THE PLACE PROVIDED ON CHILD RESTRAINT.

\*All references to age are approximates only and reference to children of average proportions. Children vary in size and shapes. The image displayed isn't indicative of the type of restraint and may vary slightly depending on the model.



**Australian  
Standard**

AS/NZS: 1754:2013  
Licence No. 25324-2  
SAI Global

## Rear Facing Mode (Use For Infants)

REFER TO PAGES 10-16

### SETUP

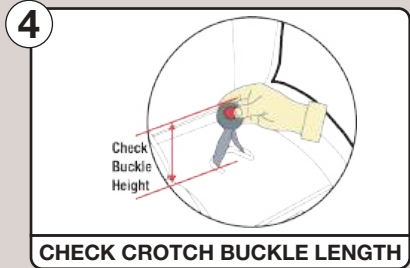
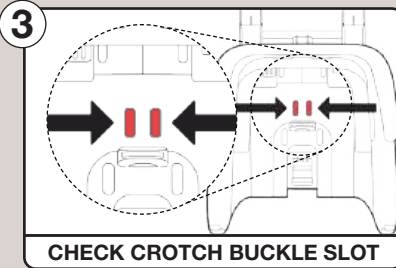
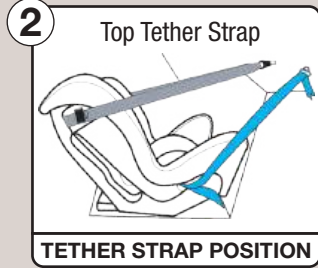
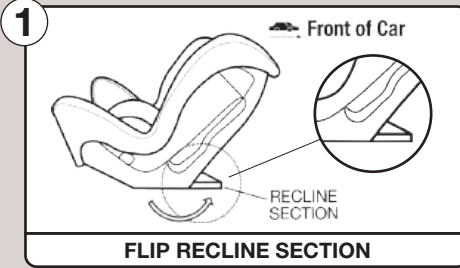

## Rear Facing Mode (Use For Infants)

### SLOT SELECTION

REFER TO PAGE 17-18

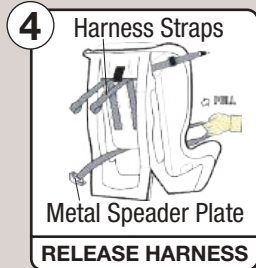
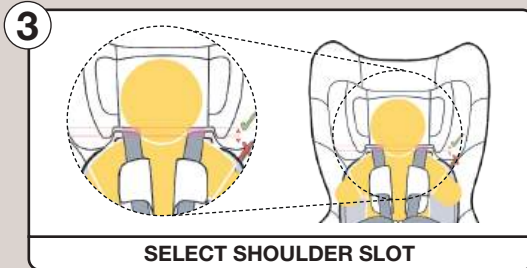

## Rear Facing Mode (Use For Infants)

REFER TO PAGES 19-22

### INSTALLATION

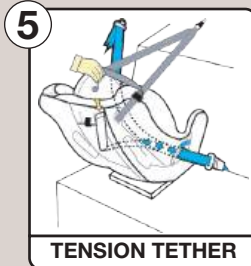
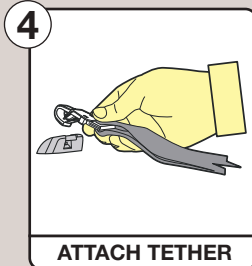
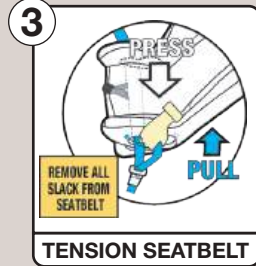
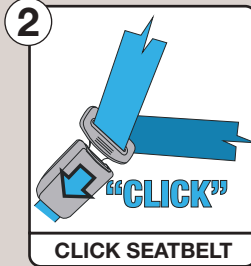
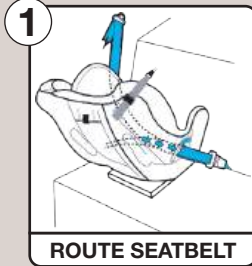

REFER TO PAGES 23-26

### USE

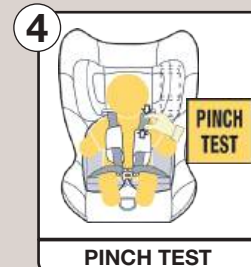
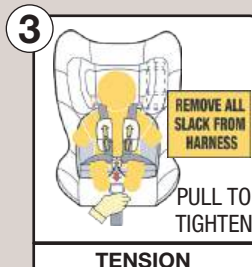
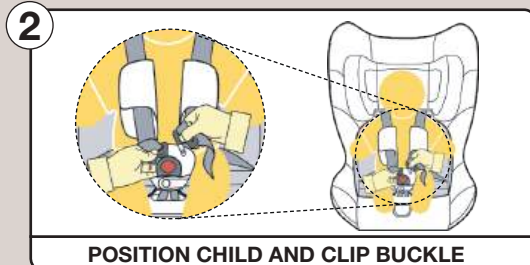
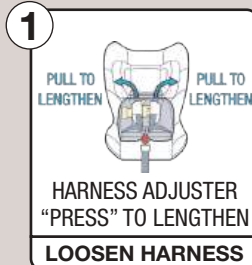

## Forward Facing Mode (Use for Toddlers)

### SETUP

### REFER TO PAGES

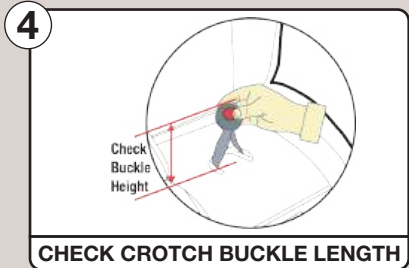
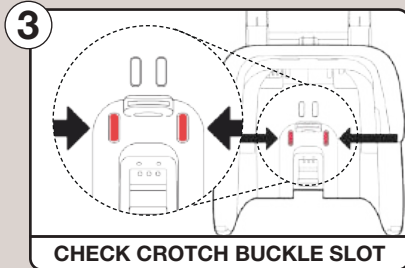
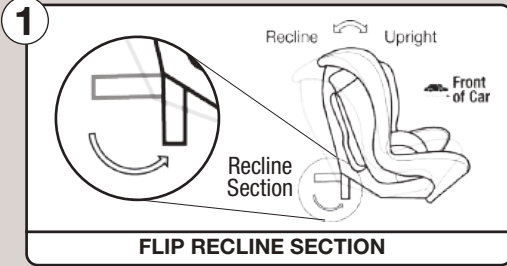

## Forward Facing Mode (Use for Toddlers)

### SETUP

REFER TO PAGES 32-35

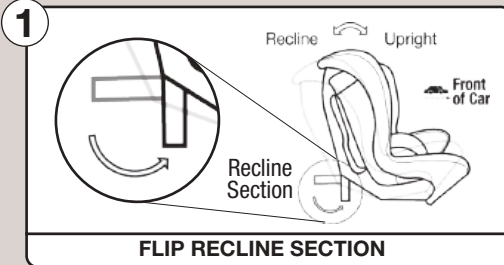

### SLOT SELECTION

REFER TO PAGES 35-37

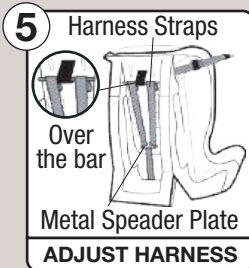
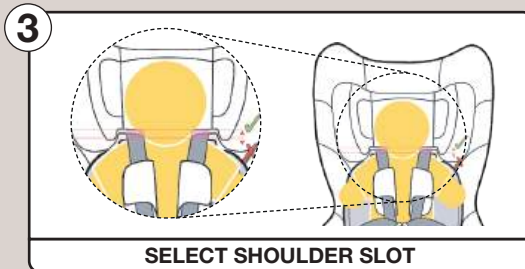
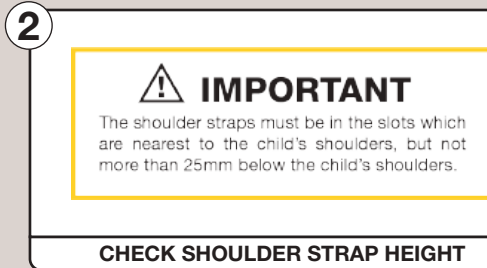
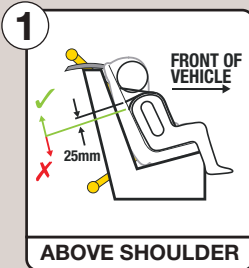

## Forward Facing Mode (Use for Toddlers)

### INSTALLATION

REFER TO PAGES 38-40

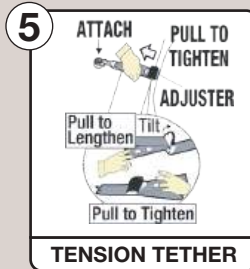
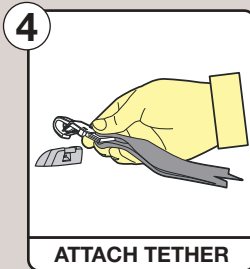
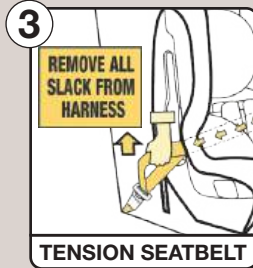
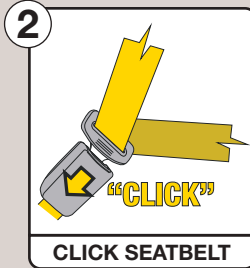
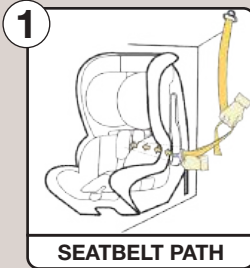

### USE

REFER TO PAGES 41-43

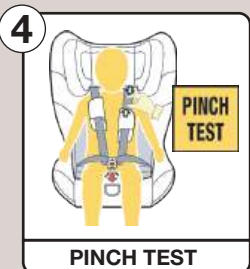
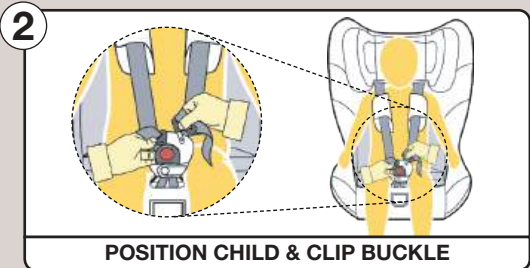
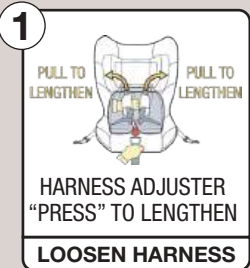

# Contents

|                 |   |
|-----------------|---|
| Contents        | 1 |
| Information     | 2 |
| Warnings        | 3 |
| Seat Types      | 5 |
| Padding/Inserts | 6 |

## Infant Seat

|  |    |
|--|----|
| Information                                    | 7  |
| CS3013 Child Restraints (Itemised List)        | 8  |
| Shoulder Height Marker                         | 9  |
| Setup  |    |
| - General                                      | 10 |
| - Selection of Appropriate Padding Combination | 11 |
| - Converting to Infant Seat                    | 12 |
| - Crotch Buckle Location                       | 14 |
| - Buckle Height Adjustment                     | 15 |
| - Recline Angle                                | 16 |
| - Shoulder Height                              | 16 |
| - Slot Height Selection                        | 17 |
| - Adjusting Harness Strap Position             | 18 |
| Installation                                   |    |
| - Installing Using Vehicle Seatbelts           | 19 |
| Use  |    |
| - Using Inbuilt Harness                        | 23 |
| - To Release Infant                            | 26 |

## Child Car Seat

|   |    |
|---|----|
| Information                                     | 27 |
| CS3013 Child Restraints (Itemised List)         | 28 |
| Shoulder Height Marker                          | 29 |
| Next Restraint                                  | 31 |
| Setup   |    |
| - Crotch Buckle Location                        | 32 |
| - Buckle Height Adjustment                      | 33 |
| - Selection of Appropriate Padding Combinations | 34 |
| - Converting to Child Car Seat                  | 34 |
| - Shoulder Height                               | 35 |
| - Headrest & Harness Strap Height Adjustment    | 37 |
| Installation                                    |    |
| - Installing Using Vehicle Seatbelt             | 38 |
| Use   |    |
| - Using Inbuilt Harness                         | 41 |
| Care of Restraint                               |    |
| - Care and Maintenance                          | 44 |
| - Cleaning                                      | 45 |
| Remove & Replace Covers                         | 47 |
| Extension Straps                                | 48 |
| Accessories                                     | 49 |
| Anchorage Fittings                              | 51 |
| Lifetime Warranty                               | 55 |
| Insurers Information                            | 56 |

# Information

This instruction manual covers various models under the Model number CS3013. This restraint is installed in the rear of the vehicle and can be used either rearward-facing or forward-facing. It can be installed in the vehicle using the vehicle seatbelt & the top tether strap. This Convertible Car Seat is designed to be used by children from birth up to approximately 4 years of age.

## **Infa Group**

Infa Group is a family owned and operated business located in Sydney, Australia. With over 65 Years experience in Juvenile Products, our mission is to deliver Safety and Innovation.

Infa Group strives to create a real difference for our customers. We design and manufacture safe, stylish and affordable Child Restraints and Nursery products. All products are engineered to a high quality and standard so that your young ones will be secure in an Infa Group product.

## **Child Restraints**

No child restraint can guarantee absolute protection from injury in every crash. However, to ensure that your child gets all the protection designed into the restraint please read and follow the instructions exactly and use only InfaSecure recommended parts and accessories.



Australian Owned™

# Warnings



## WARNINGS

- Use the restraint exactly as shown in the instructions.
- Supervision of children is needed because they may be able to undo buckles.
- **DO NOT LEAVE CHILDREN UNATTENDED IN THE CAR.**
- Do not alter or modify this restraint.
- Repairs must only be done by the manufacturers or agent.
- Do not allow the restraint to come into contact with polishes, oils, bleach and other chemicals.
- Destroy the restraint if it has been in a severe crash, even if no damage is visible.
- **DO NOT USE THIS RESTRAINT WITHOUT THE COVER.**
- To ensure infant's back is evenly supported, do not put more than one nappy on the baby and make sure the nappy is not thickly folded at the back.
- **DO NOT USE A REAR-FACING CHILD RESTRAINT WHERE AN AIRBAG IS FITTED IN FRONT OF THE SEATING POSITION.**
- Fit the restraint firmly to the car seat.
- Fit the harness firmly to the child.
- A loose restraint or harness is dangerous.
- Do not harness an infant wrapped in a blanket or swaddled. Any blanket or wrap must only be placed over the harness and infant.
- Always secure the loose end of the top tether strap. Do not use the child restraint where this strap may fall into a split in the seat back or off the side of the seat.
- **ALWAYS ATTACH HOOK AND REMOVE SLACK**

Please read and follow this instruction manual carefully. If you have any doubts about the correct use or installation of this product, please contact Infasecure or, if outside Australia or New Zealand, your local agent. Remember, all vehicles are different. Please contact your vehicle manufacturer if you have any concerns about compatibility of this product with your vehicle.

# Warnings



## WARNINGS

- THIS RESTRAINT IS NOT SUITABLE FOR USE WHERE THE TOP TETHER STRAP MAY FALL INTO A SPLIT IN THE SEAT BACK OR OFF THE SIDE OF THE SEAT.
- THIS RESTRAINT MUST BE ATTACHED TO A CHILD RESTRAINT UPPER ANCHORAGE POINT IN THE CAR. REFER TO CAR OWNER'S HANDBOOK FOR LOCATION OF ANCHORAGE POINTS. REFER TO A CHILD RESTRAINT FITTING STATION IF NO ANCHORAGE POINTS ARE IN THE MOTOR CAR.
- Always secure the loose end of the top tether strap to prevent it hanging out of the car or being accessible by the child. Do not use the child restraint where this strap may fall into a split into the seat back or off the side of the seat.
- IF AN AIRBAG IS FITTED IN THE SEATING POSITION WHERE THE CHILD RESTRAINT IS TO BE FITTED, FOLLOW THE VEHICLE MANUFACTURER'S WARNINGS AND INSTRUCTIONS.
- This child restraint is not approved for use with any connectors that connect to the cars ISOFIX low anchorages



## WARNING

**DO NOT LEAVE CHILDREN UNATTENDED IN THE CAR.**



## IMPORTANT

There is a real potential for an infant to be ejected and killed if the baby is wrapped in a blanket or swaddled. The harness needs to fit the baby firmly and any blanket or other covering may only be placed over the harness after the harness is adjusted firmly. Please ensure the baby's arms and legs are not bound or wrapped together.

For use in countries other than Australia and New Zealand

- The child restraint may not be accepted for use in cars.
- Consult the country's local authorities, car hire companies, car insurance companies, etc. for advice.

# Seat Types

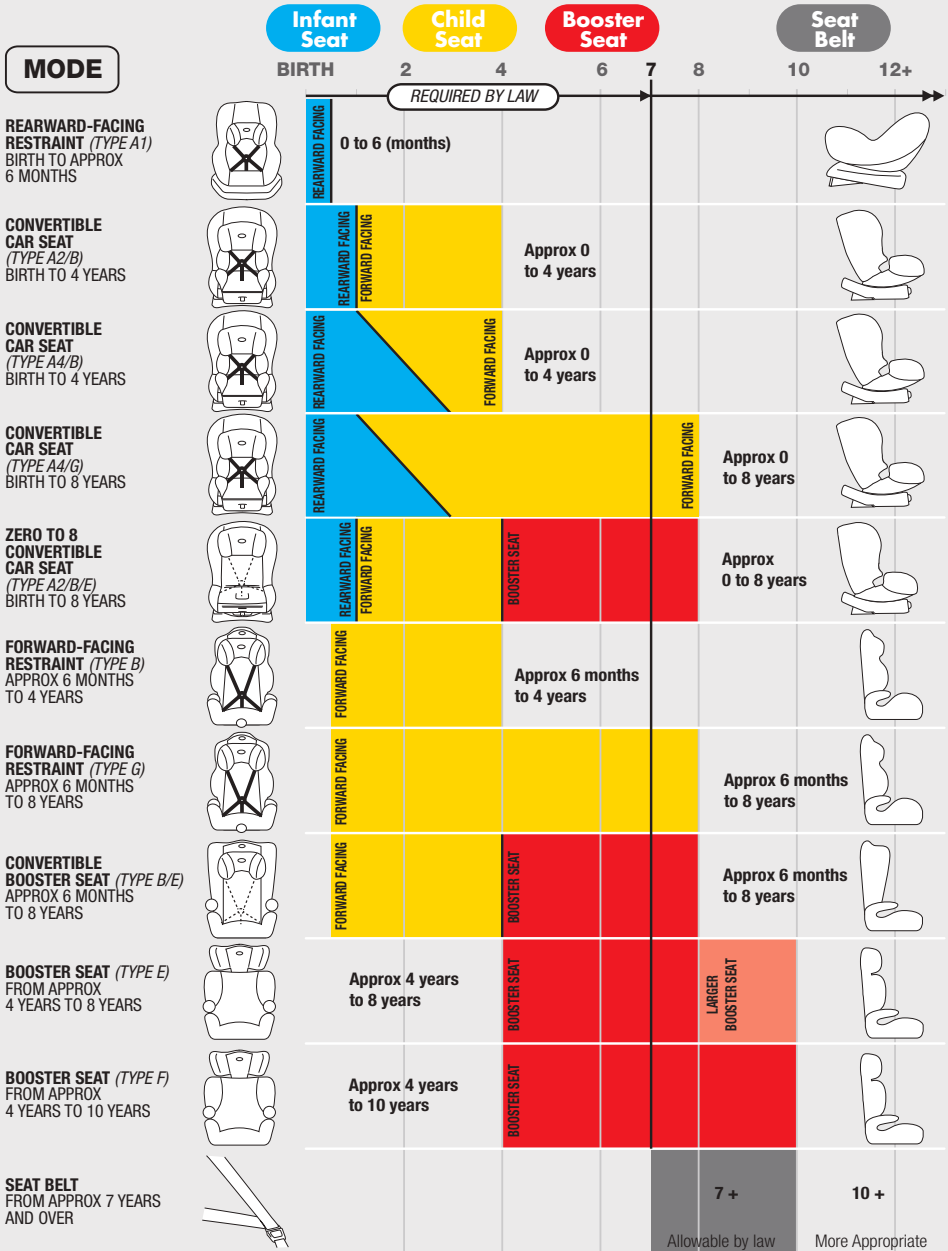

REQUIRED BY LAW

Allowable by law

More Appropriate

**IMPORTANT:** Research has shown that the likelihood of an accessory child safety harness being used incorrectly is very high and the risk of injuries when incorrectly used is much higher compared to a lap-sash seat belt. InfaSecure recommend that an accessory child safety harness should only be used if a lap-only seat belt is all that is available.

# Padding / Inserts

## Combination Guide

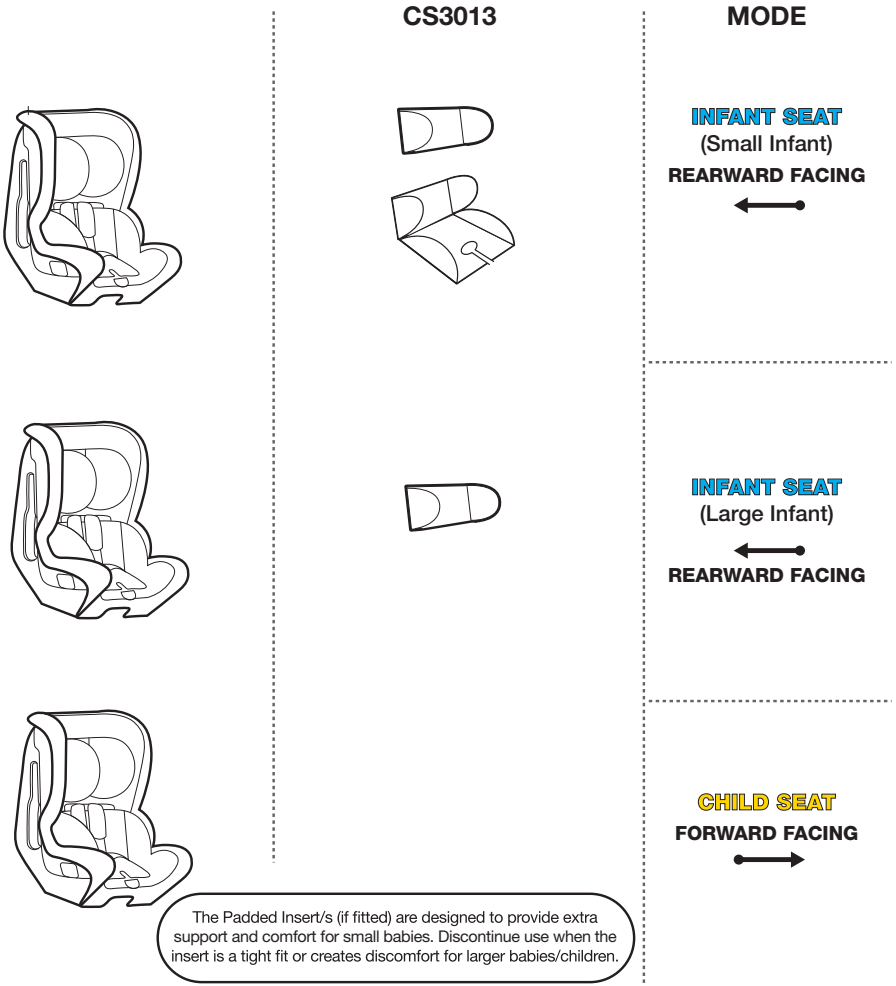

- Diagrams are indicative of type of paddings and inserts and may not resemble the actual product.
- Padded inserts can vary according to model.
- We reserve the right to alter this product without notice.

\*For detailed description and method of attachment for padded accessories refer to Accessories on page 49.

# Infant Seat (Rearward Facing)

## THE SUITABILITY OF THE CHILD RESTRAINT TO GROUPS OF CHILDREN

Type A2

To be used only in a rearward-facing position until the infant's shoulders reach the shoulder height marker (approximately 12 months of age).

Continue to use this child restraint until the child reaches this limit.

Do not use forward-facing until child's shoulders are above the lower shoulder height marker.

Infants are at risk of serious injury if they face forward too early.

Children are at risk of serious injury if they move to booster seats too early.

Just using a seatbelt is not recommended for children that have outgrown this restraint.

Children are safest in a booster seat until their shoulders reach the upper shoulder height marker of the booster seat.

## TO BE USED WITH A LAP-SASH/LAP-ONLY SEAT BELT IN THE BACK OF MOST CARS WITH FORWARD FACING SEATS.

The use of child restraints in the front seat may be restricted for children of specific ages by local legislation. Please check with your local Department of Transport for the specific seating locations of children using child restraints for their given ages.



## IMPORTANT

- ONLY USE RESTRAINT REARWARD-FACING
- Do not use the restraint without the upper anchorage strap correctly attached.
- DO NOT USE A REAR-FACING CHILD RESTRAINT WHERE AN AIRBAG IS FITTED IN THE FRONT OF THE SEATING POSITION.
- Do not use on any vehicle seat which faces sideways or rearward.
- Do not use the child restraint facing forward.
- Do not use excessively upright or reclined.
- For a vehicle without a fixed parcel shelf an extension strap(s) may be needed. If so ring 1300 92 4632 (AU) or +61 2 4728 8090 (NZ) for nearest supply location (refer page 50).
- Seatbelt extenders are not recommended to be used if the seatbelt is not long enough to secure the child restraint. If seatbelts are too short then advice should be sought from a child restraint fitter and their recommendation be considered before using a seatbelt extender.

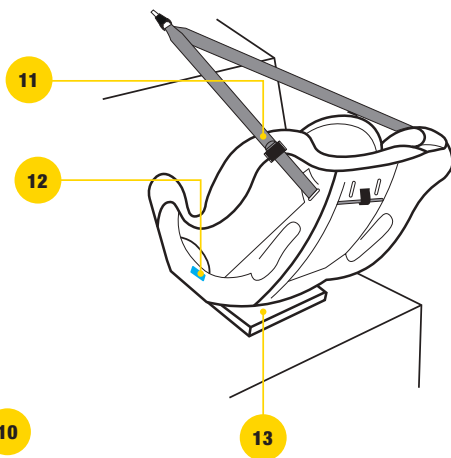
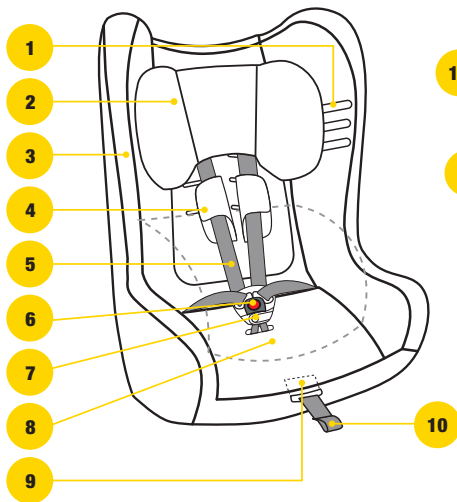

1. Shoulder Height Markers
2. Height adjustable headrest
3. Comfort Cover
4. Harness Pads (if fitted)
5. Harness Straps
6. Adjustable Buckle
7. Buckle Pad
8. Padded Insert (if fitted)
9. Harness Adjuster
10. Harness Adjustment Strap

11. Top Tether Assembly
  - Tether Strap
  - Adjuster
  - Attachment Clip
  - Anchor Fitting + Attachment Hardware
12. "REARWARD-FACING SEAT BELT PATH" Marker (each side of restraint - coloured blue)
13. Recline foot plate

NOTE: Padded inserts can vary according to model. For detailed description and method of attachment for padded accessories refer to Accessories on page 49.

# Shoulder Height Markers

## Infant (Rearward Facing Mode)

Shoulder height markers are provided on this restraint for a visual indication that the child is safe to travel in this restraint.

*Do not turn to forward facing until the child's shoulder reaches the lower label.*

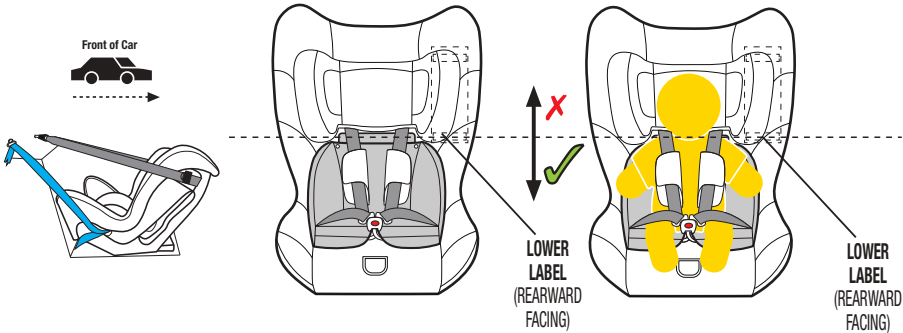

*Shoulder height markers may be hidden under the headrest in the lowest position*

To be used only in a rearward-facing position for an infant until their shoulders **REACH** the Lower shoulder height marker (approximately 12 months of age).

LOWER LABEL (Rearward-Facing)



### **IMPORTANT**

Ensure that you continue to use this child restraint in rearward facing positions whilst the infants shoulders are **below** this shoulder height marker (Lower label).

Infants are at risk of serious injury if they face forward too early.

If the infants shoulders are below the lower label or if the baby's neck muscles are unable to support their head, then the infant should remain rear facing. When the child's shoulder reach the lower label, the child restraint may be turned to face towards the front of the car (refer page 28 Child Seat section).

# Setup

## General

- The CS3013 Child restraint has been designed and tested to meet the joint Australian/New Zealand Standard with an inbuilt anti rebound feature and does not require additional anti rebound bars or mechanisms to fulfil these requirements.
- The CS3013 Child restraint has also been designed to be a compact restraint to enable multiple restraints to be used in the rear of most vehicles.

### **IMPORTANT**

- Care and attention should be given to ensure that the baby has adequate ventilation and shading when in the restraint.
- To achieve the necessary distribution of deceleration forces during a vehicle impact, ensure the child is seated correctly in the child restraint and the harness is fitted and adjusted as per these instructions.
- Ensure the child restraint and child are rearward facing.

If the baby's neck muscles are unable to support their head, then the infant should remain rear facing.

The Purchaser should check the measurement between the front of the seat back of the rear seat and all front seats in the car in which the child restraint is intended to be used, to ensure that the space is sufficient.

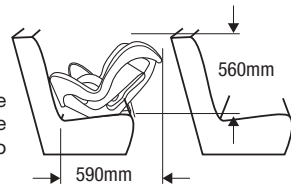

### **WARNING**

- ONLY USE RESTRAINT IN REARWARD-FACING MODE WITH "RECLINE SECTION" IN THE RECLINE POSITION LOCKED IN PLACE AND RESTRAINT FULLY RECLINED.
- Do not use the restraint without the upper anchorage strap correctly attached.
- DO NOT USE A REAR-FACING CHILD RESTRAINT WHERE AN AIRBAG IS FITTED IN THE FRONT OF THE SEATING POSITION.
- Do not use on any vehicle seat which faces sideways or rearward.

# Set Up

## Selection of Appropriate Padding Combinations

**Step 1:** Determine whether your infant/child requires the additional padding provided with this restraint, to ensure a safe and snug fit in the restraint. Refer to page 6 for suggested padding combinations.



### WARNING

- To ensure baby's back is evenly supported, do not put more than one nappy on the baby and make sure the nappy is not thickly folded at the back.

## Converting to Infant Seat

### Reclined Mode



### IMPORTANT

USE THIS POSITION ONLY FOR  
REARWARD FACING INSTALLATION

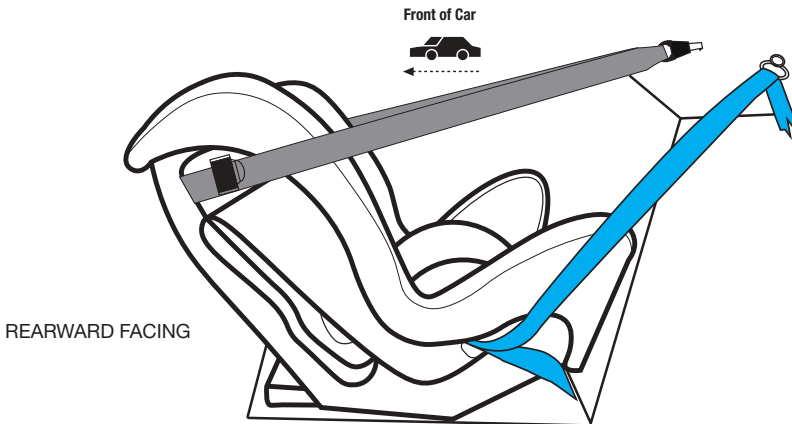

### Converting to Infant Seat

#### Reclined Position

- Step 1:** Turn the Child Restraint upside down to access from the bottom. Then Lift and Pull the Recline Foot out of the base (see Figure 1).
- Step 2:** Rotate the Recline Foot to the first position (see Figure 2).
- Step 3:** Push and Lock Recline Foot into the intended position inside the base (see Figure 3 & 4).

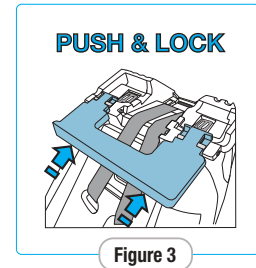
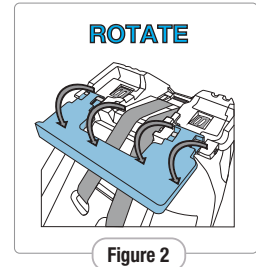
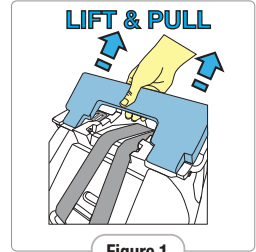

#### Front of Car

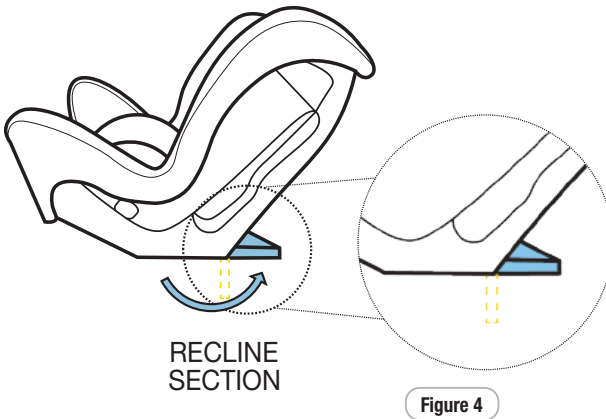

#### Recline Foot Positions

**Position 1:** Rearward facing

**Position 2:** Forward facing

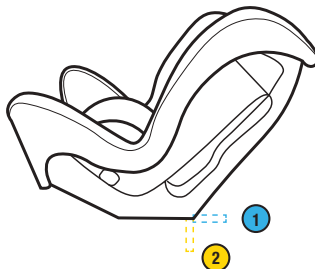

### Converting to Infant Seat

#### Reclined Position

**NOTE:** If your vehicle seats have a steep angle you can use packing such as a firmly rolled towel between the vehicle seat and the underside of the restraint to change the angle. You must ensure the restraint is firmly held in the car seat with the seat belt if you are using packing. You must also ensure that nothing has come loose every time you drive. (refer Figure 1)

#### Top Tether Adjuster Position

The position of the adjuster (top tether strap) has been factory set to enable installation in the Rear Passenger Side position. It is possible to relocate the adjuster to the other side of the restraint, but this should only be done by a qualified and experienced child restraint installer.

**Step 1:** The top tether will have one twist between the adjuster and the side of the restraint (refer to figure 2).

**Step 2:** The adjuster is positioned to enable the adjuster to face the rear passenger side door (refer to figure 2).

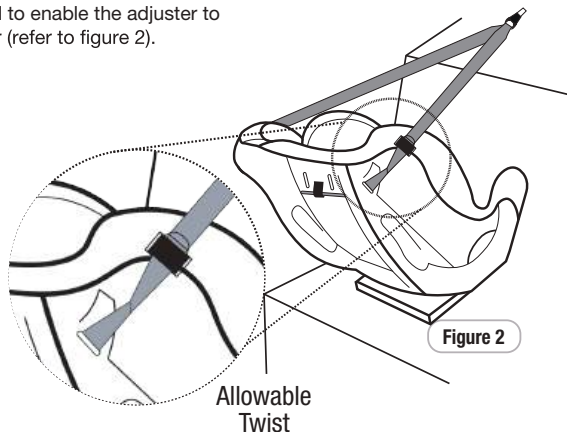
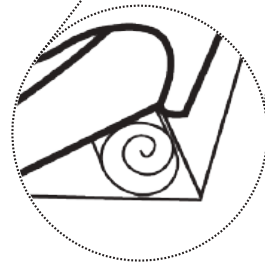
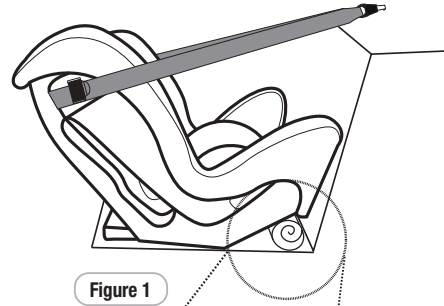

### Crotch Buckle Location

The buckle is supplied using the a slot closest to the back of the seat. When the restraint is rear facing the buckle must be in the slot as shown.

If the crotch buckle is not located in this slot you can move it using the following process:

**Step 1:** Lift the elastic edge of the seat cover up from the base of the seat.

**Step 2:** Release buckle tongues from the crotch buckle and take off any buckle covers, if present.

**Step 3:** Tilt one side of the buckle to the side and pull it through the slot. Then do the same thing on the other side.

**Step 4:** Tilt the buckle as you put the bottom buckle into the slot closest to the seat back and then push it all the way through. Keep as many twists out of the strap and do the same with the other side.

**Step 5:** Push the buckle through the cover and refit the cover and any buckle covers.

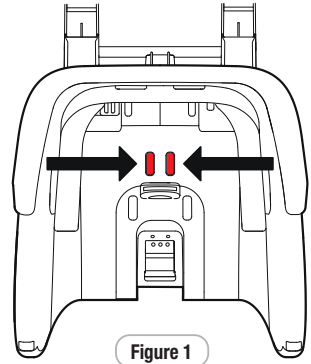

Figure 1

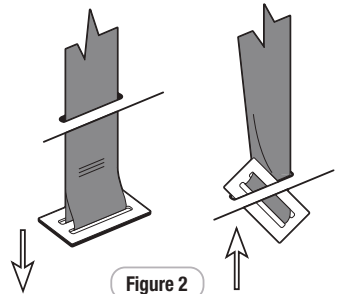

Figure 2

**Stop using this crotch buckle position when the crotch straps are no longer in front of baby. Instructions for changing crotch buckle position can be found on page 32.**

### Buckle Height Adjustment

The buckle is supplied in a shortened position for infants. If you want to alter the buckle height the following steps are required.

- Step 1:** Lift the buckle to see how much height you need (Refer Figure 1)
- Step 2:** Turn the seat over to expose the crotch buckle adjuster plate
- Step 3:** Adjust the webbing through the central plate.
- To shorten the buckle 'Pull' excess webbing through the central plate.
  - To lengthen the buckle 'Push' excess webbing through the central 3 bar plate. (refer Figure 2)

**Step 4:** Lift the buckle to check the height

**Note:** The bottom of the crotch buckle should be level with the top of the thighs.

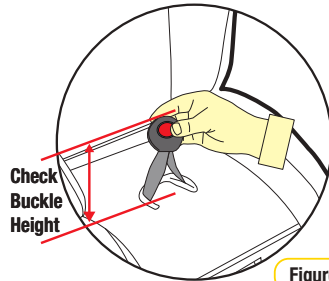

Figure 1

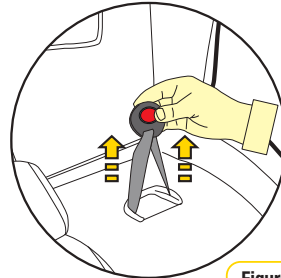
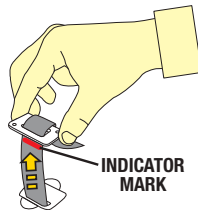
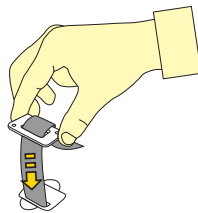
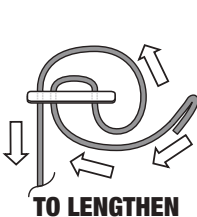

Figure 2



**Note:** Do not adjust the crotch buckle length past the red line on the strap.



# Set Up

## Recline Angle

All car seats are different and sometimes when a car seat is too angled or too flat, a child in a restraint can be too upright or too reclined. A rearward facing child restraint should always be installed so the child's head can lie back comfortably. Check your child passenger in their restraint with harnesses adjusted and tightened to make sure the angle is correct.

**⚠ IMPORTANT**

Your infant should NEVER be too upright or too recline.

**TOO UPRIGHT** (less than 55° from vertical) could lead to the infants head flopping forward and potentially causing breathing problems.

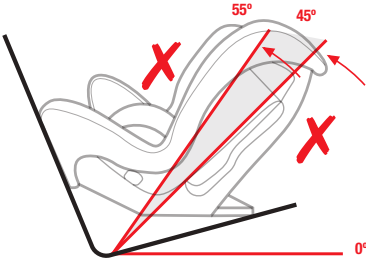

**TOO RECLINED** (greater than 45° from horizontal) could lead to the infants body sliding 'up' towards the top of the restraint in a crash which can cause injury.

**NOTE:** An accurate method of measuring the recline angle of your infant is to use a smart phone with a application that can measure angles but if using this method ensure the car is on a level surface.\***A firmly packed towel can be used to adjust recline angle if required.**

## Shoulder Height

The correct height for the shoulder straps is very important for the optimum performance of the restraint.

**⚠ IMPORTANT**

The shoulder straps must be in the slots which are nearest to the child's shoulders, but not lower than the child's shoulders.

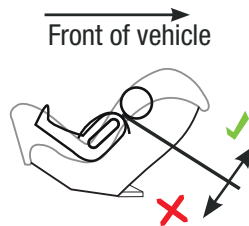

Figure 1

With the child correctly sitting in the restraint, check which set of slots (In the plastic shell of the restraint) are level with or just above the infant's shoulders.

If the harness straps are located in those slots, then the you can proceed with using the restraint (see section "USE" on page 0). If not then adjust the shoulder straps.

# Set Up

## Slot Height Selection

**Step 1:** Place child into the restraint and select the appropriate shoulder slots nearest or above the child's shoulder.

**Step 2:** If required (see Adjusting Harness Strap Position page 18).

**NOTE:** With reference to Figure 1 you should visually see the slots at or above the child's shoulder.



### IMPORTANT

The shoulder straps must be in the slots which are nearest to the child's shoulders, but not be lower than the child's shoulders.

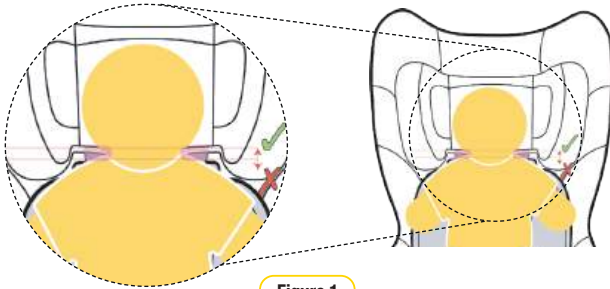

Figure 1

**Step 1:** Check to sight the location of the appropriate shoulder slots (in main shell), refer Figure 2.

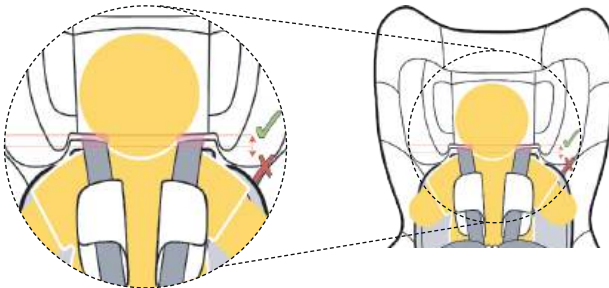

Figure 2

## Setup

### Adjusting Harness Strap Position

- Loosen harness to allow spreader plate to rise from under the restraint. Turn the restraint so that the back of the restraint is facing you (refer Figure 1.1).
- Remove each shoulder harness through the gates in the spreader plate (see Figure 1.2).
- Pull the shoulder harness straps through the shoulder slot holes in the restraint body and cover. They are now loose in the front of the restraint (see Figure 1.3).
- Push the ends of the shoulder harness straps through the appropriate shoulder slot holes in the cover and restraint body for the child's shoulder height (see Figure 1.4).

**NOTE:** Ensure the harness straps are not twisted.

The shoulder harness straps go from the shoulder slot holes, over the top bar and onto the spreader plate. Thread each shoulder harness strap back onto the metal spreader plate through the gate (see Figure 1.4) .

### IMPORTANT

- The shoulder straps must be in the slots which are nearest to the child's shoulders, but not lower than the child's shoulders.
- Always adjust the height of the shoulder straps as the child grows.

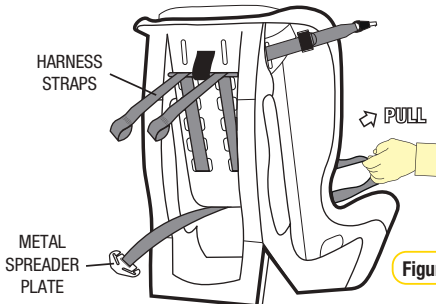

Figure 1.3

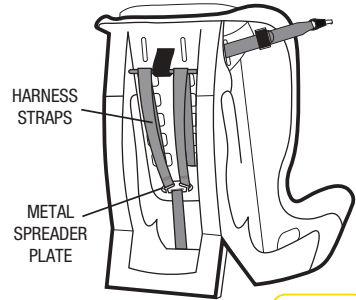

Figure 1.1

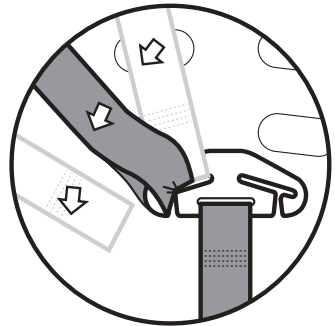

Figure 1.2

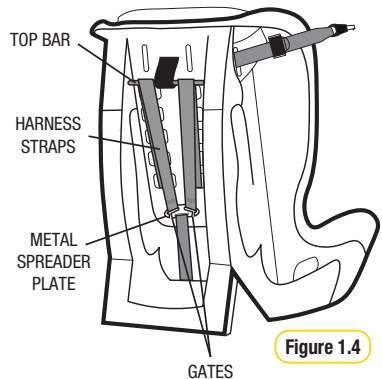

Figure 1.4

# Installation

## Installing Using Vehicle Seatbelts

**Step 1:** Place the child restraint on the vehicle seat. Ensure the child restraint is set up correctly for the size of the passenger (Figure 1).

**!** **IMPORTANT**

Ensure that you use the  
**REARWARD-FACING BELT PATH**  
identified by the following label.

↑

REARWARD  
FACING  
BELT PATH

↑

**Step 3:** Feed the adult lap or lap sash belt through the belt path opening (Figure 2 & 3).

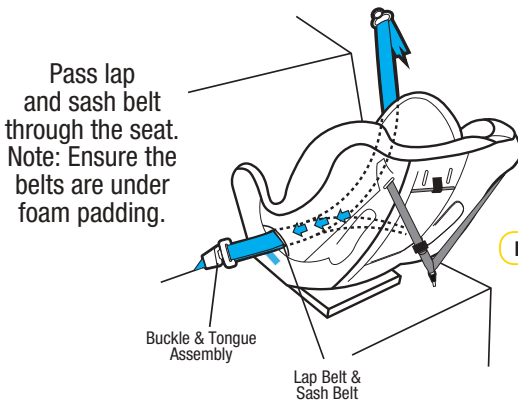
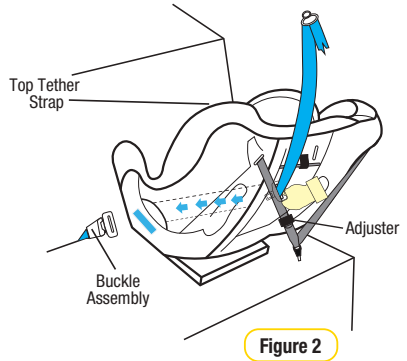
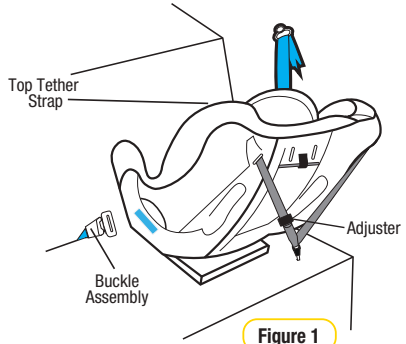

# Installation

## Installing Using Vehicle Seatbelts

**Step 5:** Engage the buckle and tongue assembly (listen for a "Click"). Check the buckle engagement with a gentle pull (Figure 4 & 5).

**NOTE:** If you need more recline place a firm packing such as a rolled up towel between the vehicle seat and the underside of the restraint.

 Front of Car

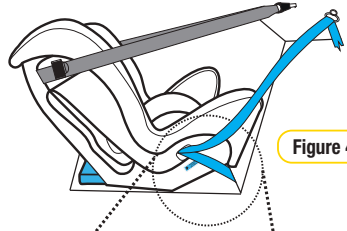
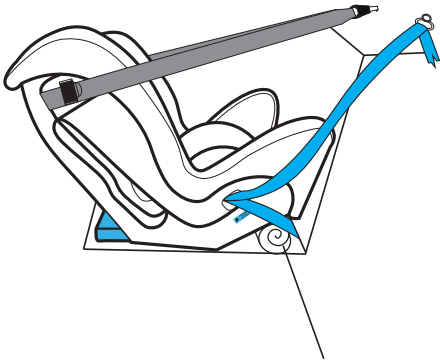

Figure 4



Firmly packed towel (optional)

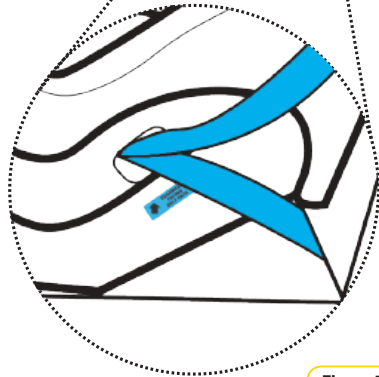

Figure 5

# Installation

## Installing Using Vehicle Seatbelts

**Note:** If no upper anchorage fitting is available refer to pages 51-53.

**Step 8:** Locate the adjuster at the side of the restraint. It is acceptable to have a twist behind the adjuster (refer Figure 9).

**Step 9:** Hook the attachment clip to the upper anchor fitting (refer Figure 10).

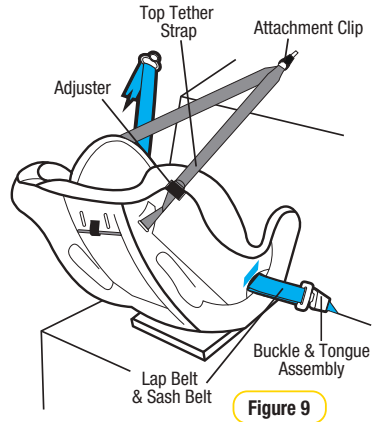

### IMPORTANT

- Please check the measurements between the front of the seat back of the rear seat and all front seats in the car in which the child restraint is intended to be used, to ensure that the space is sufficient. Care and attention should be given to
  - sufficient ventilation and shading of the baby.
- Always secure the loose end of the top tether strap to prevent it hanging out of the car or being accessible by the child.

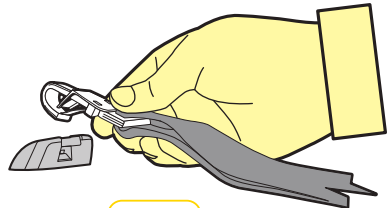

### WARNING

- DO NOT USE REAR FACING CHILD RESTRAINT WHERE AN AIRBAG IS FITTED IN FRONT OF THE SEATING POSITION.
- FIT THE RESTRAINT FIRMLY TO THE CAR SEAT.
- THIS TETHER STRAP MUST ALWAYS BE FITTED WHEN THE CHILD RESTRAINT IS USED IN A VEHICLE.

# Installation

## Installing Using Vehicle Seatbelts

**Step 8:** Pull to tighten to remove all the slack from the upper anchorage strap. **Do not overtighten** as this could cause the restraint to lift off the vehicle seat (refer Figure 12).

### IMPORTANT

- Tighten till slack is removed.
- In certain vehicles an extension strap may be needed.
- **DO NOT OVERTIGHTEN** top tether strap.

**Step 8:** Store any excess webbing, from the top tether strap, in the storage pocket provided on the restraint (refer Figure 13).

**CAUTION: CHILDREN CAN BE INJURED OR RESTRAINTS AND TOP TETHER STRAP DAMAGED BY UNSECURED CARGO IN A COLLISION. SECURE OR REMOVE HAZARDOUS CARGO BEFORE USING THIS CHILD RESTRAINT.**

Always secure the loose end of the top tether strap to prevent it hanging out of the car or being accessible by the child.

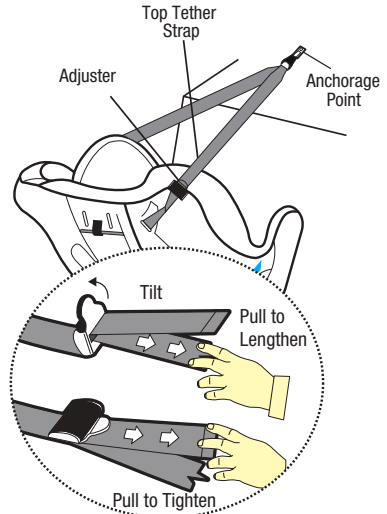

Figure 12

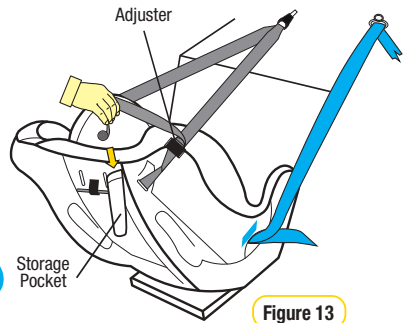

Figure 13

## Tether Storage

After correctly installing the restraint in your car, roll up and place any excess tether strap in the storage pocket provided (refer Figure 13).

### NOTE

**FOLLOWING INSTALLATION, A SMALL AMOUNT OF LEFT - RIGHT MOVEMENT IS DEEMED ACCEPTABLE. AN OVERTIGHTENED TOP TETHER STRAP CAN CAUSE EXCESSIVE MOVEMENT.**

### Using Inbuilt Harness

- Step 1:** Ensure the restraint has been installed and set up as per "Setup" and "Installation" (refer page 10-13)
- Step 2:** To lengthen the harness "PRESS" the harness adjuster (refer Figure 2) whilst grasping both shoulder harness straps and pulling. Ensure shoulder straps are pulled equally on each side.

#### **WARNING**

To ensure infant's back is evenly supported, do not put more than one nappy on the baby and make sure the nappy is not thickly folded at the back.

- Step 3:** Place the child in the restraint with legs either side of the buckle, place the harness over the shoulders and hips (refer Figure 3).

**NOTE:** Ensure child is positioned back into the restraint (or child's back contacting the restraint).

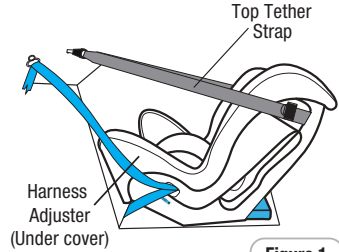
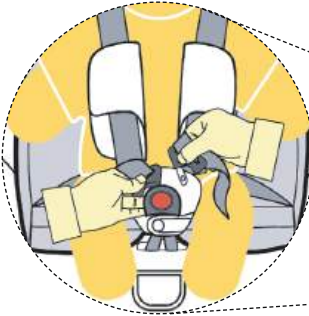

Figure 1

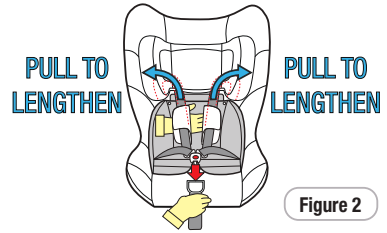

Figure 2

HARNES ADJUSTER "PRESS" TO LENGTHEN

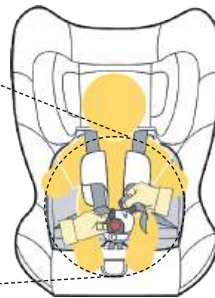

Figure 3

#### **IMPORTANT** **KEEP BUCKLE LOW AS POSSIBLE**

Make sure the bottom of the crotch buckle is level with the top of the thighs (see indicated area Figure 4).

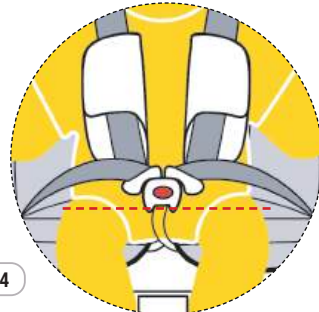

Figure 4

### Using Inbuilt Harness

**Step 4:** Insert either tongue into the buckle followed by the other tongue until a “CLICK” is heard. Should the second tongue not insert, press the red button and reinsert the tongues. Ensure secure engagement by pulling the harness strap (refer Figure 5).

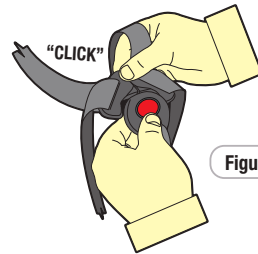
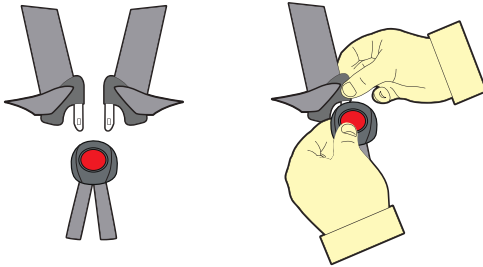

Figure 5



### IMPORTANT

If no “Click” can be heard or a secure engagement cannot be achieved refer to “Cleaning Buckle Harness” page 46.

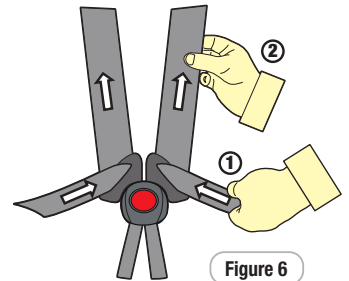

Figure 6

**Step 5:** Remove all of the slack for the harness lap straps by pulling shoulder straps (refer Figure 6), then pull the harness adjustment strap to adjust harness to a comfortable but firm fit (refer Figure 6 & 7).



### WARNINGS

- **DO NOT LEAVE CHILDREN UNATTENDED IN THE CAR.**
- Fit the harness firmly to the child.
- **A LOOSE HARNESS IS DANGEROUS.**

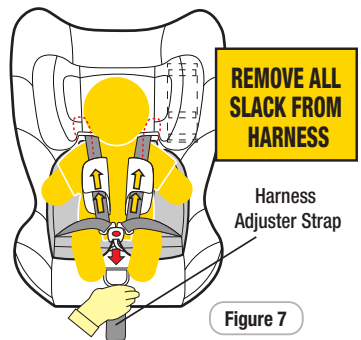

Figure 7

**PULL TO TIGHTEN**

### Using Inbuilt Harness

#### **IMPORTANT**

- The Padded Insert/s (if fitted) are designed to provide extra support and comfort for small babies. Discontinue use when the insert is a tight fit or creates discomfort for larger babies/children.
- Always adjust the height of the shoulder straps as the child grows.

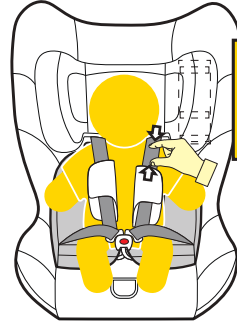

Figure 8

**NOTE:** If top tether strap has been loosened to allow easier placing of the baby in the restraint, tighten the upper anchorage strap so it has no slack in it. **DO NOT TIGHTEN EXCESSIVELY.**

- Step 6:** Check the harness tightness by the **PINCH TEST**, this is achieved by pinching the harness webbing at the shoulders (refer Figure 8)
- If you can pinch the harness strap, tighten more.
  - If your fingers slip off, then the harness is tight enough.
- If required repeat Step 5.

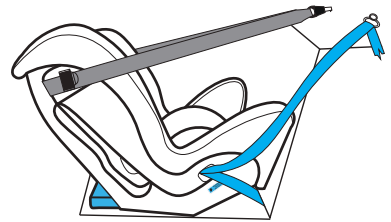

Figure 9

- Step 7:** Pull to tighten to remove all the slack from the upper tether strap. Do not overtighten as this could cause the restraint to lift off the vehicle seat (refer to Figure 9).

- Step 8:** Store any excess webbing, from the top tether strap in the storage pocket provided on the restraint (refer to Figure 10).

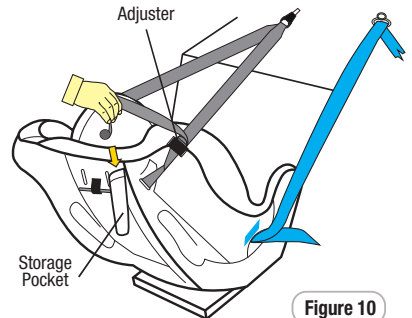

Figure 10

## Use

### To Release Infant

**Step 1:** ALWAYS loosen harnesses first

**Step 2:** Press the harness buckle to release harnesses.

**Step 3:** Hold ONLY the buckle tongues and lay them to the side of the restraint

**NOTE:** If Top Tether strap has been loosened to allow easier placing of the baby in the restraint, always retighten the Top Tether strap so it has no slack in it. DO NOT OVERTIGHTEN.

### For Ease Of Use

No need to disconnect the Upper Anchorage Strap.

To **access** your baby simply;

- Loosen upper anchorage strap (refer Figure 2).
- Lower strap out of way (refer Figure 3).

Reverse procedure when reseating the baby.



### WARNING

- Always use a lap or lap-sash seat belt and top tether strap to attach the child restraint to the vehicle.
- Do not use the restraint without the top tether strap correctly attached and adjusted.
- Do not use on any vehicle seat which faces sideways or rearwards.
- IF AN AIRBAG IS FITTED IN THE SEATING POSITION WHERE THE CHILD RESTRAINT IS TO BE FITTED, FOLLOW THE VEHICLE MANUFACTURER'S WARNINGS AND INSTRUCTIONS.
- Do not use the restraint if the buckle is sluggish or does not provide an audible "Click" refer to Cleaning Instructions on page 44.

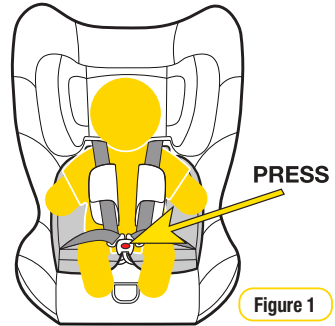

Figure 1

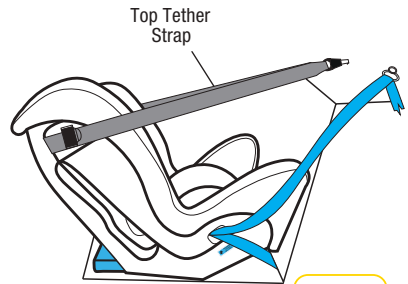

Figure 2

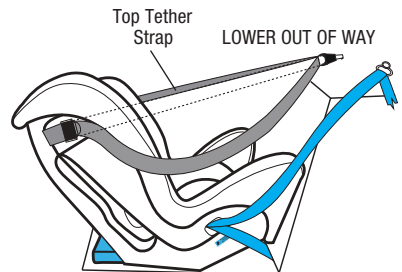

Figure 3

# Child Car Seat (Forward Facing)

## THE SUITABILITY OF THE CHILD RESTRAINT TO GROUPS OF CHILDREN

### Type A2

To be used only in a rearward-facing position until the infant's shoulders reach the shoulder height marker (approximately 12 months of age).

### Type B

To be used in a forward-facing position until the child's shoulders reach the upper shoulder height marker (approximately 4 years of age).

Continue to use this child restraint until the child shoulders reaches this limit.

Do not use forward-facing until child's shoulders are above the lower shoulder height marker.

Infants are at risk of serious injury if they face forward too early.

Children are at risk of serious injury if they move to booster seats too early.

Children who have outgrown this restraint are safest in a larger child restraint with an in-built harness or a booster seat until their shoulders reach the upper shoulder height marker of the restraint.

## TO BE USED WITH A LAP- SASH/LAP-ONLY BELT IN THE BACK OF MOST CARS WITH FORWARD FACING SEATS.

The use of child restraints in the front seat may be restricted for children of specific ages by local legislation. Please check with your local Department of Transport for the specific seating locations of children using child restraints for their given ages.



## IMPORTANT

- For a vehicle without a fixed parcel shelf an extension strap(s) may be needed. If so ring 1300 92 4632 (AU) or +61 2 4728 8090 (NZ) for nearest supply location (refer page 50).
- Seatbelt extenders are not recommended to be used if the seatbelt is not long enough to secure the child restraint. If seatbelts are too short then advice should be sought from a child restraint fitter and their recommendation be considered before using a seatbelt extender.

# Model CS3013

Forward Facing

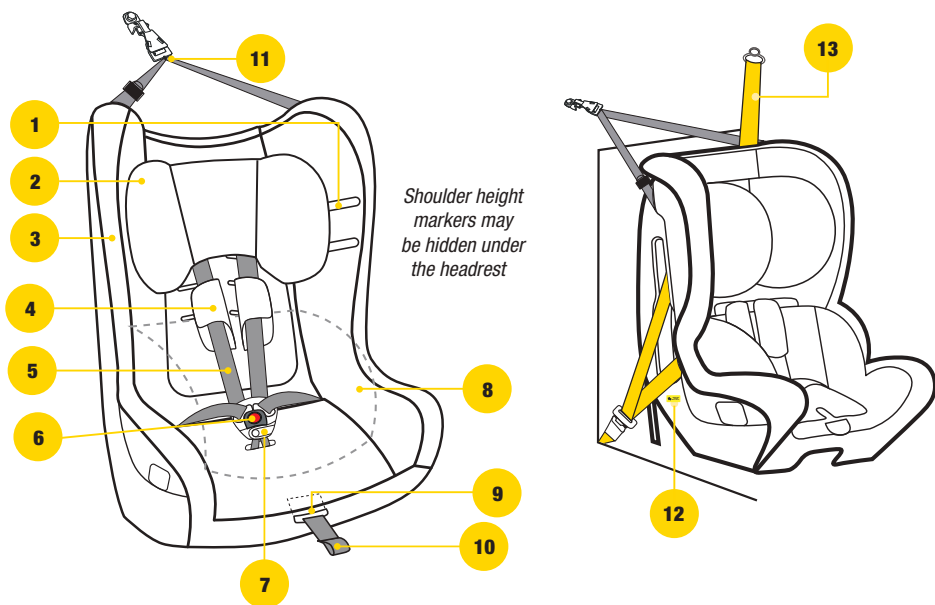

1. Shoulder Height Markers
2. Padded headrest
3. Comfort Cover
4. Harness Pads (if fitted)
5. Harness Straps
6. Adjustable Buckle
7. Buckle Pad
8. Padded Insert (if fitted)
9. Harness Adjuster
10. Harness Adjustment Strap

11. Top Tether Assembly
  - Tether Strap
  - Adjuster
  - Attachment Clip
  - Anchor Fitting + Attachment Hardware
12. "FORWARD-FACING SEAT BELT PATH" Marker (each side of restraint - coloured yellow)
13. Vehicle Seat belt

NOTE: Padded inserts can vary according to model. For detailed description and method of attachment for padded accessories refer to Accessories on page 51.



# Shoulder Height Marker

## Taller Toddler (Using Inbuilt Harness)

Do not continue to use the restraint if the child's shoulder are above the Upper Label.

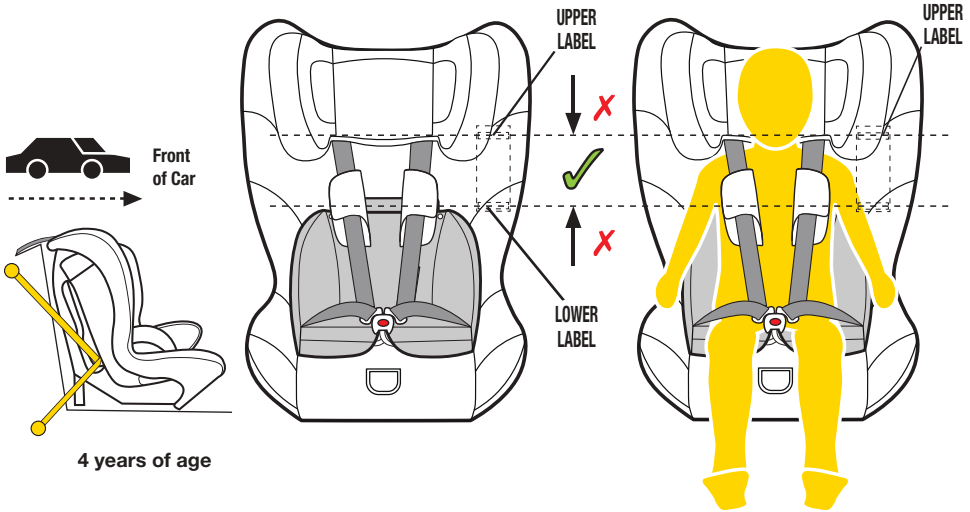

Continue to use this forward-facing child restraint until the child's shoulders **REACH** the Upper shoulder height marker (Upper Label).

UPPER LABEL (Forward-Facing)

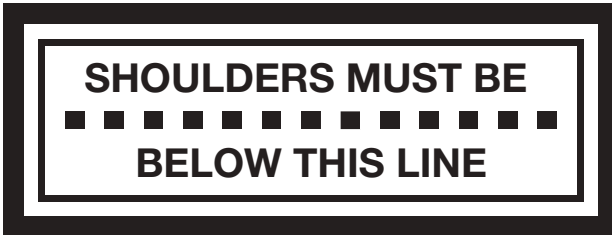

Children are at risk of serious injury if they move to booster seats too early.

Children that have outgrown the forward-facing child restraint are safest in a booster seat until their shoulders reach the upper shoulder height marker of the booster seat.

The child restraint is unsuitable for the occupant when the shoulders are above the upper marker. The child needs to be moved into the next form of child restraint eg. Type E booster seat or Type F booster seat when they reach the top shoulder height marker.

For the next child restraint refer to the Restraint Guide on page 5 and 31.

# Next Restraint

## Next Type of Restraint

Refer to the 'RESTRAINT GUIDE' for the selection for the most appropriate next restraint (refer page 5). When the child has outgrown the child car seat, then you can use either of the following;

- **Convertible booster seat** - Type (B/E) internal harness until approximately 4 years old and then as a booster seat with vehicle lap-sash seatbelt until approximately 8 years (refer Figure 1).
- **Booster seat** - Type (E) booster seat with vehicle lap-sash seatbelt approximately 4 - 8 years old (refer Figure 2).
- **Child car seat**- Type (G) harnessed child restraint suitable approximately 6 months to 8 years (refer Figure 3).

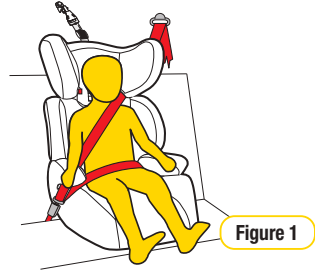

### Crotch Buckle Location

The buckle is supplied using the a slot closest to the back of the seat. When the restraint is forward facing the buckle must be in the slot as shown.

If the crotch buckle is not located in this slot you can move it using the following process:

**Step 1:** Lift the elastic edge of the seat cover up from the base of the seat.

**Step 2:** Release buckle tongues from the crotch buckle and take off any buckle covers, if present.

**Step 3:** Tilt one side of the buckle to the side and pull it through the slot. Then do the same thing on the other side.

**Step 4:** Tilt the buckle as you put the bottom buckle into the slot closest to the front of the seat and then push it all the way through. Keep as many twists out of the strap and do the same with the other side.

**Step 5:** Push the buckle through the cover and refit the cover and any buckle covers.

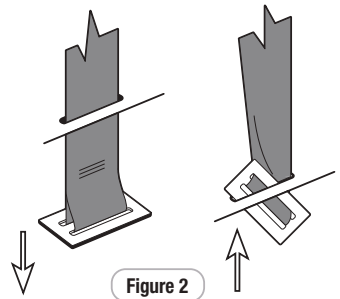
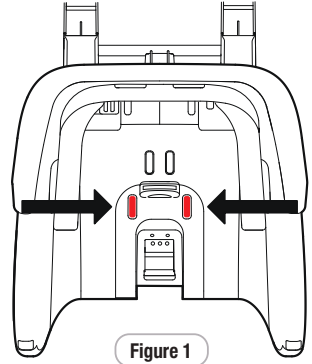

### Buckle Height Adjustment

The buckle is supplied in a shortened position for infants. If you want to alter the buckle height the following steps are required.

- Step 1:** Lift the buckle to see how much height you need (Refer Figure 1)
- Step 2:** Turn the seat over to expose the crotch buckle adjuster plate.
- Step 3:** Adjust the webbing through the central plate.
- To shorten the buckle 'Pull' excess webbing through the central plate.
  - To lengthen the buckle 'Push' excess webbing through the central 3 bar plate. (refer Figure 2)
- Step 4:** Lift the buckle to check the height.

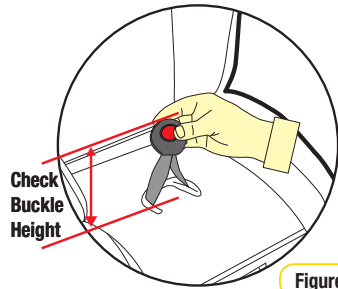

Figure 1

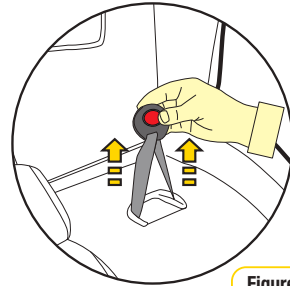
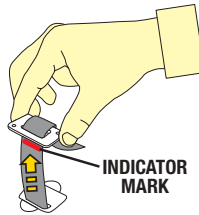
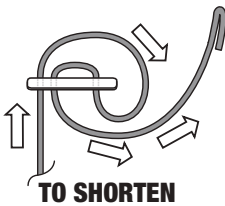
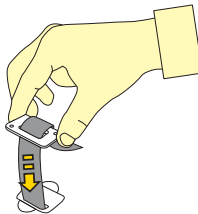
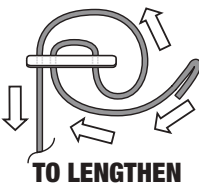

Figure 2

**Note: The bottom of the crotch buckle should be level with the top of the thighs.**



**Note: Do not adjust the crotch buckle length past the red line on the strap.**



### Selection of Appropriate Padding Combinations

**Step 1:** Determine whether your child requires the additional padding provided with this restraint, to ensure a safe and snug fit in the restraint. Refer to page 6 for suggested padding combinations.

### Converting to Child Car Seat

**Step 1:** Turn the child restraint over and pull the recline foot out of the locked position (Figure 1).

**Step 2:** Rotate the recline foot as shown (Figure 2).

**Step 3:** Push to lock the recline foot into place (Figure 3 & 4).

 **Front of Car**

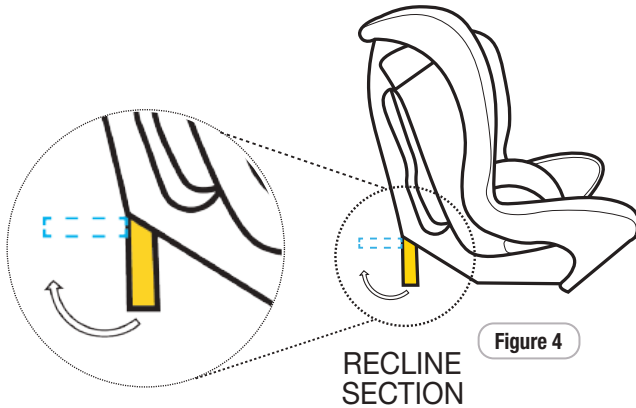

Figure 4

**LIFT & PULL**

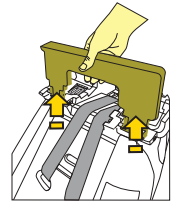

Figure 1

**ROTATE**

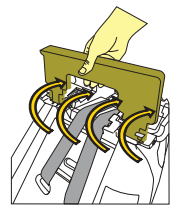

Figure 2

**PUSH & LOCK**

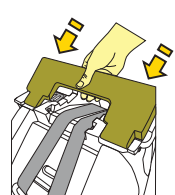

Figure 3

# Setup

## Shoulder Height

The correct height for the shoulder straps is very important for the optimum performance of the restraint. The shoulder strap slots used in forward facing position are the upper and middle positions.



### IMPORTANT

The shoulder straps must be positioned nearest to the child's shoulders, but not more than 25mm below the child's shoulders.

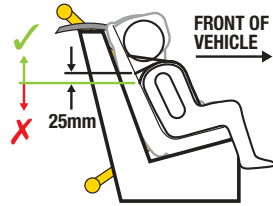

# Setup

## Shoulder Height

### Zone

The child's shoulder region.

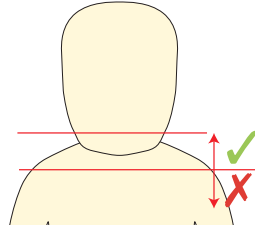

### Slot Position

Nearest to the child's shoulders, but not more than 25mm below the child's shoulders.

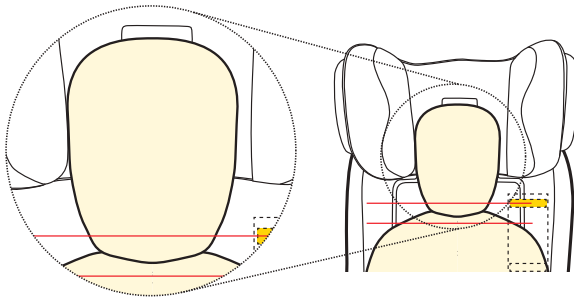

### Headrest Position

Check to confirm that the Harness position is just above the shoulders.

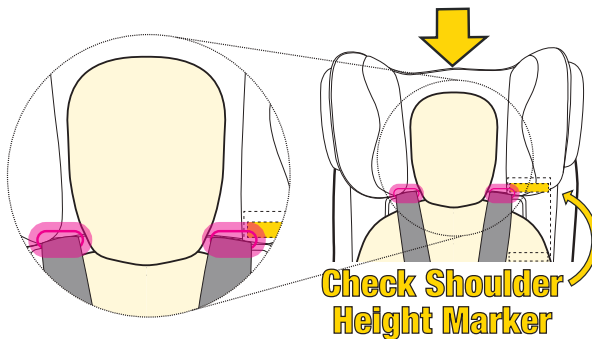

# Setup

## Adjusting Harness Strap Position

- Loosen harness to allow spreader plate to rise from under the restraint. Turn the restraint so that the back of the restraint is facing you (refer Figure 1.1).
- Remove each shoulder harness through the gates in the spreader plate (refer Figure 1.2).
- Pull the shoulder harness straps through the shoulder slot holes in the restraint body and cover. They are now loose in the front of the restraint (refer Figure 1.3).
- Push the ends of the shoulder harness straps through the appropriate shoulder slot holes in the headrest and restraint body for the child's shoulder height.

**NOTE:** Ensure the harness straps are not twisted.

The shoulder harness straps go from the shoulder slot holes, over the top bar and onto the spreader plate. Thread each shoulder harness strap back onto the metal spreader plate through the gate (see Figure 1.4).

### IMPORTANT

The shoulder straps must be in the slots which are nearest to the child's shoulders, but not more than 25mm below the child's shoulders.

With the child correctly sitting in the restraint, check which set of slots (in the plastic shell of the restraint) are level with but not more than 25mm below the child's shoulders.

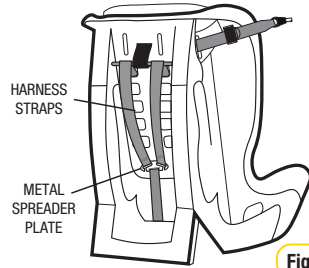

Figure 1.1

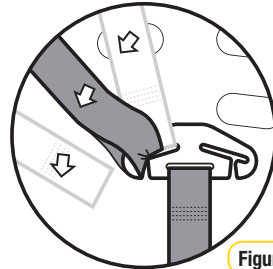

Figure 1.2

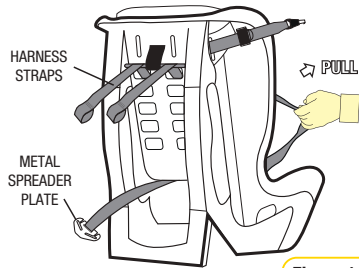

Figure 1.3

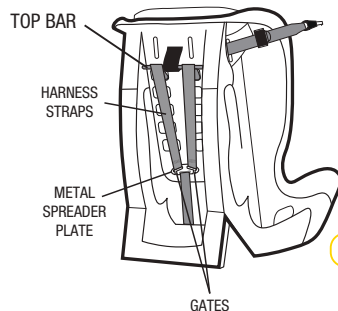

Figure 1.4

# Installation

## Installing Using Vehicle Seatbelt

**Step 1:** Place the restraint in the vehicle with the back of the restraint against the seat, and in line with the anchorage point.

### **IMPORTANT**

- Do not use the restraint with harness shoulder straps set at different heights.
- Ensure that all straps have been secured correctly by pulling on each strap.
- Ensure that the harness straps are not twisted.
- Always adjust the height of the shoulder straps as the child grows.

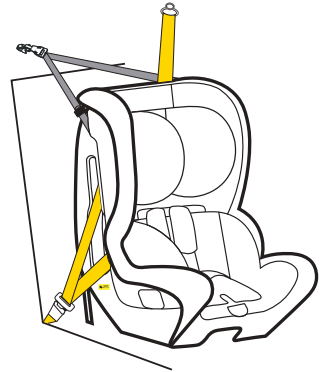

### **IMPORTANT**

Ensure that you use the  
**FORWARD-FACING BELT PATH**  
identified by the following label.

**FORWARD  
FACING  
BELT PATH**

# Installation

## Installing Using Vehicle Seatbelt

**Step 2:** Feed the adult seat belt through the belt path at the rear of the restraint. ENSURE THE SEAT BELT DOES NOT PASS UNDERNEATH THE HARNESS STRAPS AT THE BACK OF THE RESTRAINT (see Figure 1).

Engage the buckle and tongue assembly (listen for a “CLICK”). Check the buckle engagement with a gentle pull (see Figure 2).

 **WARNING**

- Always use Top Tether strap to attach the child restraint to the vehicle.
- Do not use the restraint without the Top Tether strap correctly attached and adjusted.
- Do not use on any vehicle seat which faces sideways or rearwards.
- IF AN AIRBAG IS FITTED IN THE SEATING POSITION WHERE THE CHILD RESTRAINT IS TO BE FITTED, FOLLOW THE VEHICLE MANUFACTURER’S WARNINGS AND INSTRUCTIONS.
- Fit the restraint firmly to the car seat.

Pass the seat belt through the seat, Ensure the seat belt is NOT underneath the harness straps.

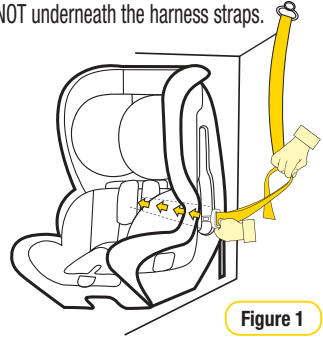

Figure 1

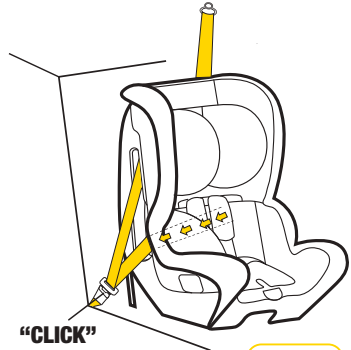

Figure 2

**Step 3:** Push down on the base of the restraint (with knee or hand) whilst pulling the sash section of the vehicle belt firmly up in direction of the yellow arrow in Figure 3 (This will tighten the lap belt across the restraint base).

**Step 4:** Ensure the excess slack in the sash belt, is fed back towards the seat belt.



Figure 3

**REMOVE ALL SLACK FROM BELT**

# Installation

## Installing Using Top Tether Strap

**Note:** If no upper anchorage fitting is available refer to pages 51-53.

**Step 5:** Hook the attachment clip to the anchor fitting. Ensure there are no twists in the top tether strap (refer to Figure 4).

**Step 6:** Pull to tighten to remove all the slack, from the upper anchorage strap. Do not overtighten as this could cause the restraint to lift off the vehicle seat (refer to Figure 5).

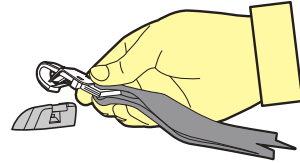

Figure 4

### NOTE

**FOLLOWING THE INSTALLATION OF THE CHILD RESTRAINT A SMALL AMOUNT OF MOVEMENT IS DEEMED ACCEPTABLE.**

**CAUTION: CHILDREN CAN BE INJURED OR RESTRAINTS AND TOP TETHER STRAP DAMAGED BY UNSECURED CARGO IN A COLLISION. SECURE OR REMOVE HAZARDOUS CARGO BEFORE USING THIS CHILD RESTRAINT.**

Always secure the loose end of the top tether strap to prevent it hanging out of the car or being accessible by the child.

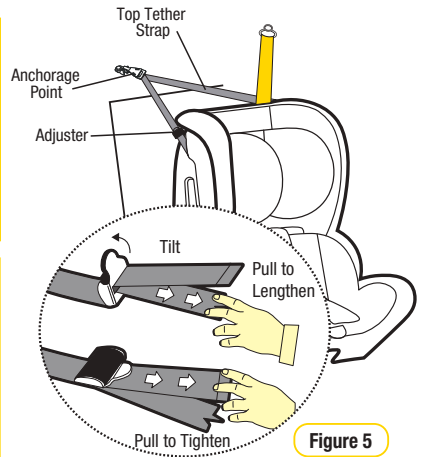

Figure 5

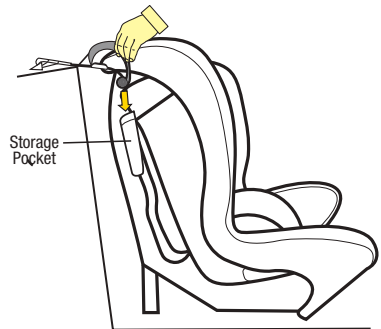

Figure 6

### Tether Storage

After correctly installing the restraint in your car, roll up and place any excess strap in the storage pocket provided (refer Figure 6).

# Use

## Using Inbuilt Harness

- Step 1:** Ensure the restraint has been installed and set up as per “Set Up” and “Installation” (refer page 35-40).
- Step 2:** To lengthen the harness “PRESS” the harness adjuster (refer Figure 1) whilst grasping both shoulder harness straps and pulling. Ensure shoulder straps are pulled equally on each side.
- Step 3:** Place child in car seat with legs either side of the buckle, place harness over the shoulders and hips. (refer Figure 2).

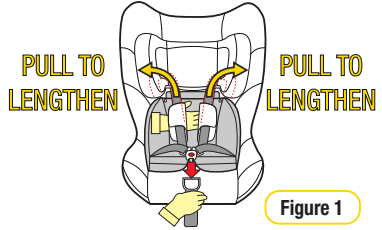

Figure 1

HARNESS ADJUSTER  
“PRESS” TO LENGTHEN

**NOTE:** To change the buckle height refer to Buckle Height Adjustment (refer page 33).

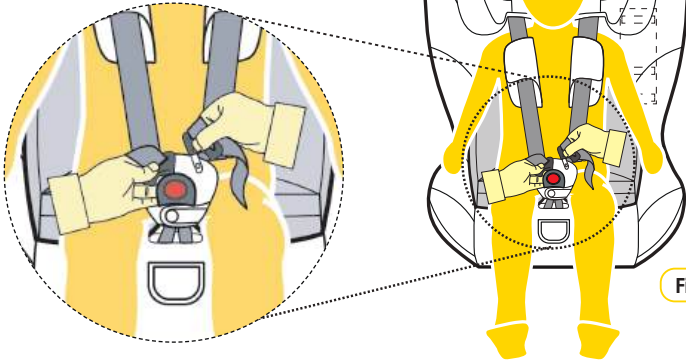

Figure 2



### IMPORTANT

**KEEP BUCKLE AS LOW AS POSSIBLE**

Make sure the bottom of the crotch buckle is level with the top of the thighs (see indicated area Figure 3).

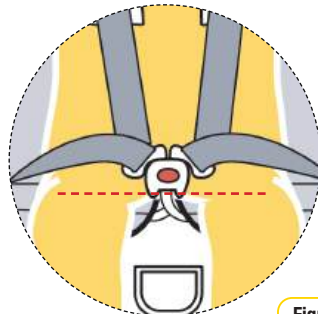

Figure 3

# Use

## Using Inbuilt Harness

**Step 4:** Insert either tongue into the buckle followed by the other tongue until a **“CLICK”** is heard. Should the second tongue not insert, press the red button and reinsert the tongues. Ensure secure engagement by pulling the harness strap (refer Figure 4).

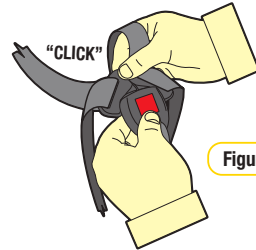
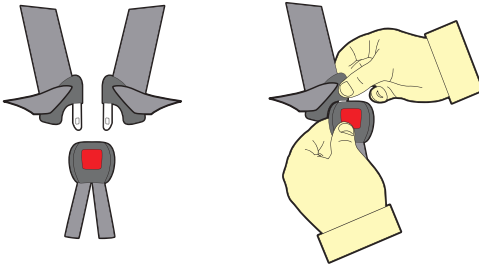

Figure 4

**! IMPORTANT**  
 If no “Click” can be heard or a secure engagement cannot be achieved refer to Cleaning Buckle Harness page 46.

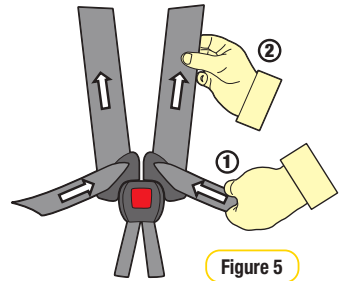

Figure 5

**Step 5:** Remove all of the slack for the harness lap straps by pulling shoulder straps (refer Figure 5), then pull the harness adjustment strap to adjust harness to a comfortable but firm fit (refer to Figure 5 & 6).

**! WARNINGS**

- **DO NOT LEAVE CHILDREN UNATTENDED IN THE CAR.**
- Fit the harness firmly to the child.
- **A LOOSE RESTRAINT OR HARNESS IS DANGEROUS**

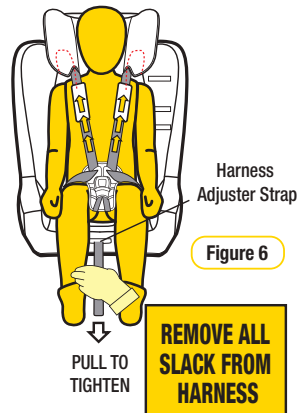

Figure 6

## Use

### Using Inbuilt Harness

- Step 6:** Check the harness tightness by the **PINCH TEST**, this is achieved by pinching the harness webbing at the shoulders (refer Figure 7)
- If you can pinch the harness strap, tighten more.
  - If your fingers slip off, then the harness is tight enough.
- If required repeat Step 5.



### IMPORTANT

- **A LOOSE HARNESS IS DANGEROUS.**
- The Padded Insert/s (if fitted) are designed to provide extra support and comfort for small babies. Discontinue use when the insert is a tight fit or creates discomfort for larger babies/children.
- Always adjust the height of the shoulder straps as the child grows.

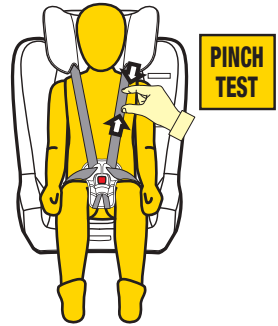

Figure 7

### To Release Child

- Step 1:** Always loosen harnesses first before taking your child out of their child restraint.
- Step 2:** To release your child from the restraint simply press the harness buckle and carefully remove your child from the restraint (refer Figure 1).

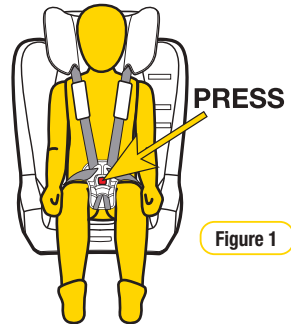
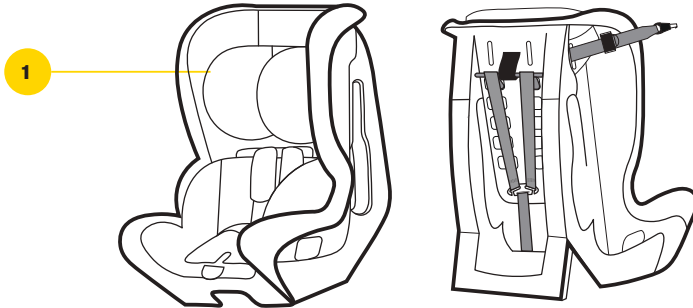

Figure 1

# Care of Restraint

The child restraint cover has been manufactured to meet the Australian Standards requirements for flammability and toxicity to ensure your child's safety. The cover has also been designed to provide your child with comfort and support.



1. Main Cover

## VERY IMPORTANT

**Only replace the cover with a InfaSecure supplied replacement cover with identical shoulder height markers or a replacement cover meeting AS/NZS 8005.**

## Care and Maintenance

Regular care of the restraint will ensure safety of your child.

- Check the webbing for fraying.
- Check the upper anchorage attachment clip to ensure retainer clip is still present.
- Ensure there are no cracks in moulding or the plastic moulding.
- Check the buckles “click” when you engage tongues and is not sluggish or sticky in operation.
- Ensure the buckle is free of fluff, liquid, or other matter that may enter the buckle slots. Clean the buckle if it is sluggish to engage (refer Cleaning Buckle page 44)
- Check the harness adjuster is operating and is clamping the webbing
- If any part of the restraint is cracked or broken, seek repair immediately or replace the child restraint.

# Cleaning



## IMPORTANT

Use only mild soap and water to clean all parts of the CS3013 Convertible Car Seat.  
Do not use chemicals or cleaning agents  
Cold water only to be used and to be rinsed well  
Do not dry clean or tumble dry  
Do not bleach.

## Covers

The restraint has a flame retardant cover which is removable for cleaning. Cleaning instructions are on the care label attached to the cover. If a fluffy cover is fitted, then washing the cover prior to use will remove excess fluff.

The cover has been designed to protect your child when seated in the restraint. Care should be taken, if children either eat or drink while in the restraint, as some food or drink products may cause damage or marking to the cover. Wash or clean immediately. Do not pull sticky items from covers as the cover may be damaged - soak in water and gently remove.

Only machine wash on gentle cycle (hand washing is recommended). When washing the covers, ensure the hook and loop attachment strips are connected to eliminate other materials or garments being caught. Ensure that the hook and loop attachment strips are free of lint, this will ensure a positive engagement.

## Seat + Hardware

Use only mild soap and water to clean all webbing, metal and plastic parts of the restraint using a damp cloth.  
Do not use chemicals or cleaning agents.

## Harness Straps

Use only mild soap and water to clean all straps, using a damp cloth the harness straps can be soaked, however they must be thoroughly dried without excessive heat (never tumble dry). The harness straps should not be placed in a washing machine as this may cause damage to the stitching or even damage your washing machine.  
Do not use chemicals or cleaning agents.

# Cleaning

## Harness Buckle

If sticky liquids such as baby formula, fruit juice, etc. get inside your Harness Buckle, it may become sluggish. An indication of a sluggish Harness Buckle is that you cannot hear a **“CLICK”** when engaging the Harness Tongues. To restore the Harness Buckle to good working order it needs to be cleaned as follows:

**Step 1:** From the underside of the restraint pull each crotch 3-bar slide then turn 3-bar slide and push through each slot to remove the Harness Buckle from the restraint (refer Figure 1).

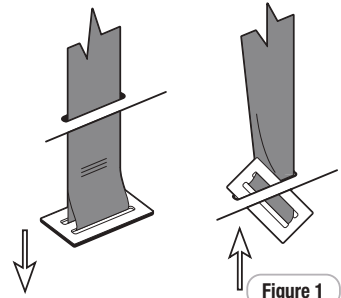

Figure 1

**Step 2:** Place the Harness Buckle under warm (max. 40 degrees Celsius) running water as shown below. Let the water run through the mouth of the buckle for five minutes (refer Figure 2).

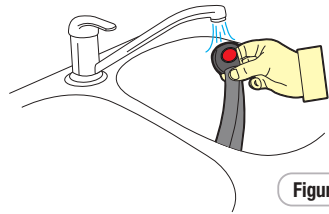

Figure 2

**Step 3:** Engage and disengage the Harness Tongues and Buckles several times until a strong audible **“CLICK”** is heard when inserting the last tongue (refer Figure 3).

**Step 4:** If you still cannot hear a strong audible click after engaging the Harness Tongues and Buckle, then repeat cleaning several times. If the Harness Buckle cannot be returned to its original working condition then contact InfaSecure Customer Care:  
AU: 1300 92 4632; NZ: 067 590 870.

**Step 5:** Refit the harness buckle to the restraint with the red button facing out and feeding each 3-bar slide through appropriate slot. Always ensure the webbing crotch straps are thoroughly dried before installing.

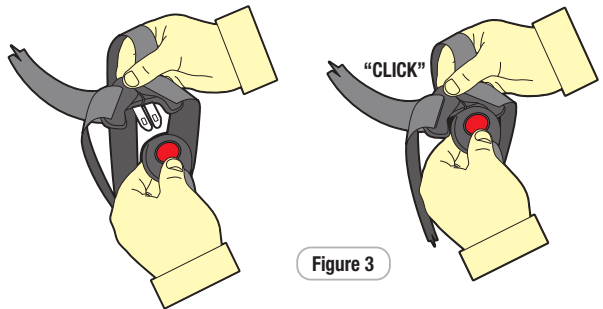

Figure 3

# Remove & Replace Covers

## Main Cover

### Remove Covers

- Step 1:** Loosen harness to allow spreader plate to rise from under the restraint. Turn the restraint so that the back of the seat is facing you (refer Figure 1 & 2 on pages 18 & 37).
- Step 2:** Remove each shoulder harness through the gates in the spreader plate (see Figure 1 & 3).
- Step 3:** Pull the shoulder harness straps through the shoulder slot holes in the seat body and cover. They are now loose in the front of the seat.

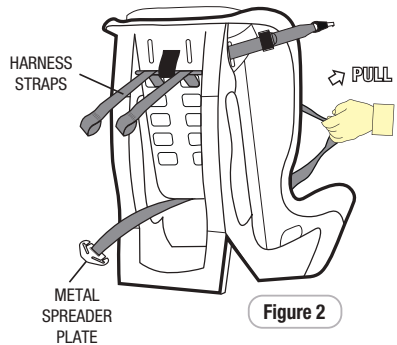
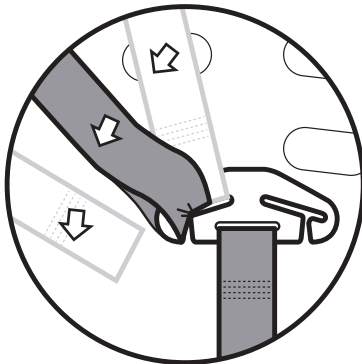
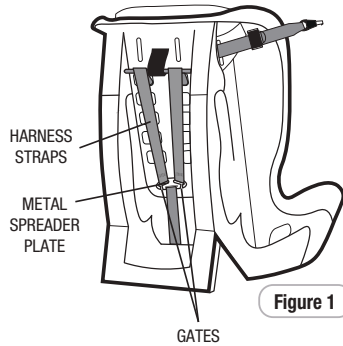

- Step 4:** Remove the elasticised headrest cover
- Step 5:** Loosed the elasticised fabric trim from all edges of the seat.
- Step 6:** Remove cover

### Install Covers

- Step 1:** Reverse the 'Remove Covers' process.

# Extension Straps

If required contact InfaSecure for your supply location. Extension straps, not included in this package, may be required for vehicles without a fixed parcel shelf.

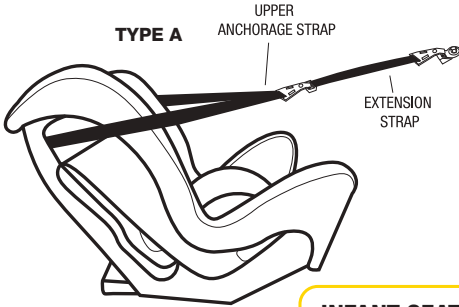

## Re order Line Numbers

- CS111 300mm Length
- CS112 600mm Length
- CS113 200mm - 900mm Adjustable Length

If required contact InfaSecure  
Customer Care 1300 92 4632 (AU)  
or 067 590 870 (NZ) for nearest  
supply location.

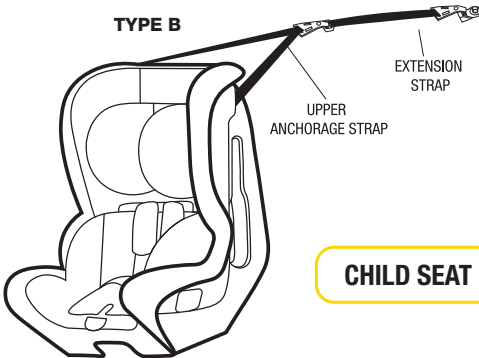

# Accessories

Follow the instructions covering the use of accessories provided with this child restraint or spare parts provided by InfaSecure for this restraint.

## IMPORTANT

Use of unauthorised aftermarket accessories (i.e items not provided in this box with the child restraint), can reduce the safety provided by the child restraint and may cause injury or death.

### **PADDED INSERTS** (if fitted)

The padded inserts are designed to add extra comfort for your child.

- Step 1:** Press to release Buckle tongues.
- Step 2:** Open the “press studs” and position the padded insert in the restraint.
- Step 3:** Pass the harness straps over the insert and connect the “press studs”.
- Step 4:** Pull the Buckle and leg straps through the slot or opening in the insert.
- Step 5:** Connect both tongues into the buckle.

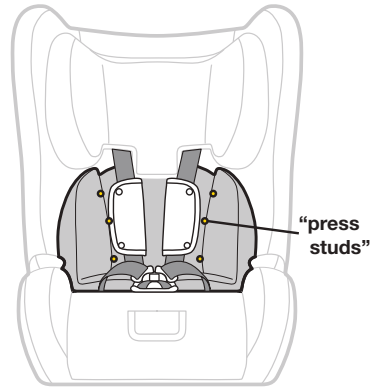

### **BUCKLE PAD** (if fitted)

The buckle pad is designed to add extra comfort for baby or child.

- Step 1:** Position the buckle pad behind the buckle and clip in the front. The release button should be clearly visible.

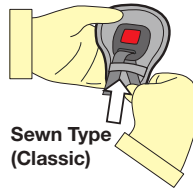

**Sewn Type  
(Classic)**

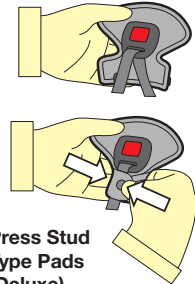

**Press Stud  
Type Pads  
(Deluxe)**

# Accessories

## SHOULDER PADS (if fitted)

**Step 1:** Separate press-studs and remove the shoulder pads from harness

**Step 2:** To attach shoulder pads, ensure press studs face away from the child and re-attach.

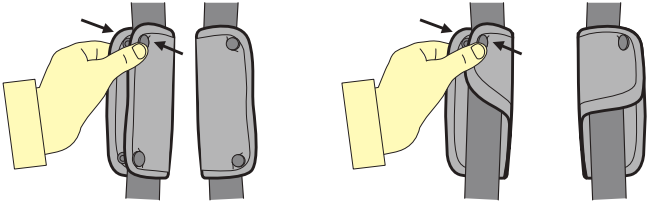

# Anchorage Fittings

Some vehicles may have an anchor fitting already fitted by the vehicle manufacturer.

If no anchorage points can be found refer to the vehicle manufacturer, or an authorised child restraint fitting station for the best location of an anchorage point.

Refer to the vehicle owners handbook or child restraint fitting station for the possible use of spacers.

Some vehicles may require the use of additional extension straps (not supplied with this child restraint)

If so ring InfaSecure on 1300 92 4632 (AU) or +61 2 4728 8090 (NZ) for nearest supply location.  
**ADDITIONAL EXTENSION STRAPS AVAILABLE:**  
 CS111 300mm Extension strap  
 CS112 600mm Extension strap  
 CS113 200 - 900mm Adjustable Extension strap



## WARNINGS

- Top tether strap and attachment clip must always be used
- Always ensure that the upper attachment clip is correctly engaged to the anchor fitting
- THIS RESTRAINT MUST BE ATTACHED TO A CHILD RESTRAINT ANCHORAGE POINT IN THE CAR. REFER TO CAR OWNER'S HANDBOOK FOR LOCATION OF ANCHORAGE POINTS. REFER TO A CHILD RESTRAINT FITTING STATION IF NO CAR ANCHORAGE POINTS ARE IN THE MOTOR CAR.
- THIS RESTRAINT IS NOT SUITABLE FOR USE WHERE TOP TETHER STRAP MAY FALL INTO A SPLIT IN THE SEAT BACK OR OFF THE SIDE OF THE SEAT.

## For cars fitted with a child restraint anchorage point

THIS RESTRAINT MUST BE ATTACHED TO A CHILD RESTRAINT ANCHORAGE POINT IN THE CAR. LOCATE THE ANCHORAGE POINT BEHIND THE REAR SEATING POSITION CONSULT THE CAR OWNER'S HANDBOOK FOR LOCATION OF ANCHORAGE POINTS. REMOVE THE THREAD PLUG FROM THE PARCEL SHELF/FLOOR/ROOF AND INSTALL THE ATTACHMENT BOLT AS SHOWN IN FIGURE 1A & 1B.

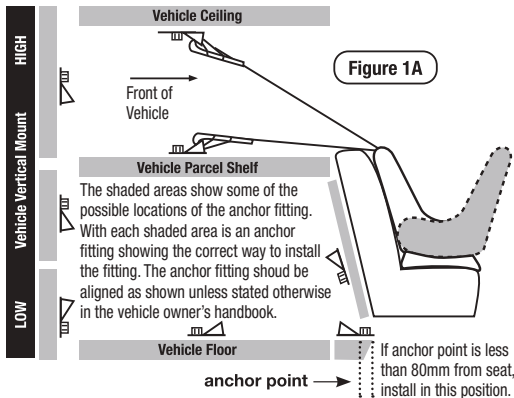

WARNING: If A.D.R. anchorage point is recessed, spacer(s) may be required. Spacer Part No's are as follows:  
 10mm - CCS001;  
 5mm - CCS002

### UPPER ANCHORAGE FITTINGS

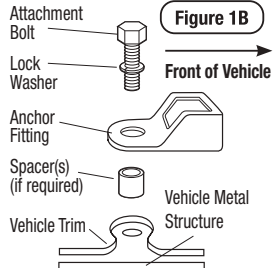

**CAUTION: DO NOT OVERTIGHTEN ATTACHMENT BOLT. MAXIMUM TORQUE IS 20NM.**

# Anchorage Fittings

## For cars not fitted with a child restraint anchorage point

### For Sedans Only

Drill a 9mm diameter hole in the parcel shelf on the centre line of the seating position as shown in Figure 1C. Hole must be no closer than 200mm from the front of the back seat. Install the anchor bolt as shown in Figure 1D.

Note to Queensland purchases: The installation of anchorage points must be approved by authorised officers appointed by Queensland Transport. Authorised officers can be sourced from all Queensland Transport Customer Service and Queensland Ambulance Service Centres.

### For Vehicles other than Sedans

In Australia, consult your nearest child restraint fitting station of traffic authority for vehicle inspection to find the best, correct position for the placement of the anchorage point, and for the correct attachment bolt length use of spacers.

In New Zealand consult the agent of the vehicle.

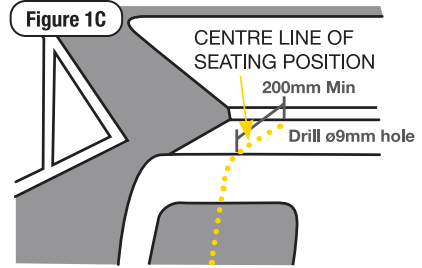

### UPPER ANCHORAGE FITTINGS FOR SEDANS ONLY

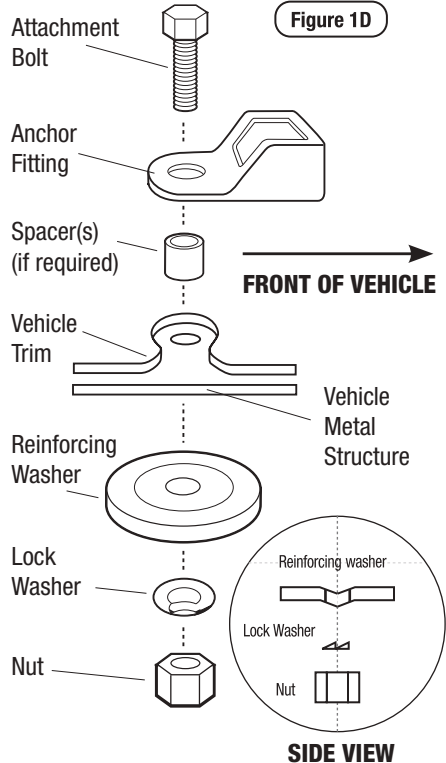

## WARNINGS

CHILD RESTRAINTS MUST NOT BE ATTACHED TO UNSOUND METAL OR WOOD OR SYNTHETIC STRUCTURES. WHEN DRILLING THE 9MM HOLE DO NOT DRILL THROUGH FUEL LINES, FUEL TANKS, ELECTRICAL WIRING OR RADIO SPEAKERS. WEBBING STRAPS MUST BE PROTECTED FROM SHARP CORNERS AND EDGES.

THE ANCHOR FITTING MUST BE USED ONLY AS DESCRIBED ABOVE. IT MUST NOT BE HOOKED ONTO ANY OTHER OBJECT.

# Notes:

A series of horizontal dotted lines for writing notes.

# Notes:

A series of horizontal dotted lines for writing notes.

# LIFETIME WARRANTY

ON SUPER STRONG BLOW MOULDED SHELL PRODUCTS

Register your product to receive **lifetime warranty\***, product updates and information.

 Please visit <https://infagroup.com.au/pages/warranty-information> to register your product.

## Infa Group Warranty

Infa Group Pty Ltd warrants this product for twelve months from the date of purchase against failure due to manufacturing faults or faulty materials. Misuse, accidental damages, normal wear and tear are not covered by this warranty.

When used for commercial use the period is limited to six months. “Our goods come with guarantees that cannot be excluded under the Australian Consumer Law. You are entitled to a replacement or refund for a major failure and for compensation for any other reasonably foreseeable loss or damage. You are also entitled to have the goods repaired or replaced if the goods fail to be of acceptable quality and the failure does not amount to a major failure.”

## Additional Warranty on Blow Moulded Child Restraints

Our blow moulded child restraints are covered against faulty materials and manufacturing when used under normal conditions and according to the instructions.

In the unlikely case that you do have a fault in relation to material quality or manufacturing that restricts your ability to use your Child Restraint normally, we will repair or replace the product within the following warranty periods from date of purchase:

- 12 month warranty for material and fabrics
- 2 year warranty for straps and webbing
- 5 year warranty for hardware and fittings
- Lifetime warranty\* on the manufacturing of the seat moulding

Please read your instruction manual carefully before using any of our products. The above express warranties do not apply where a failure or defect results from improper care, misuse or from normal wear and tear.

Refer to website for more details: [www.infagroup.com.au](http://www.infagroup.com.au)

\*Lifetime warranty refers to the life span of the seat which is 10 years from the Date of Purchase.

# Insurers Information

If your restraint has been involved in a severe crash, you should destroy the restraint even if no damage is obvious. Some insurance companies offer vehicle insurance which covers or partially covers the replacement of your child restraint. Contact your insurance company for further details.

Your insurance company may require you to keep the child restraint for assessment, but do not use the child restraint after a severe crash. To assist you in making an accident insurance claim cut the following statement and include it with your claim.

## **NOTICE TO INSURANCE COMPANY CHILD RESTRAINT INVOLVED IN AN ACCIDENT**

All InfaSecure child restraints are manufactured to Australian/New Zealand Standards AS/NZS1754 which requires us to advise users of child restraints to "Destroy the entire restraint if it has been in use in a severe crash, even if no damage is obvious".

The Australian/New Zealand Standards committee, advise that this statement applies whether a child was in the child restraint or not. We consider a "severe crash" as being one where the main body structure of the vehicle is distorted.

There is no method of determining if the restraint has been damaged and we concur with the Australian/New Zealand Standards in recommending destruction of the child restraint.

This notice is to advise you of the requirements of the Australian/New Zealand Standards and our obligation in complying with the standards.

Please assist the owner of this restraint in their claim.

**INFASECURE PTY LTD** ABN: 52 149 173 660

Head Office and Registered Address  
110-114 Old Bathurst Rd, Emu Plains, NSW 2750  
P.O. Box 487, Emu Plains, NSW 2750

Customer Care  
**AU:** 1300 92 4632  
**NZ:** 067 590 870

[www.infagroup.com.au](http://www.infagroup.com.au)







## INFA GROUP PTY LTD

ABN: 52 149 173 660

### HEAD OFFICE

110 - 114 Old Bathurst Rd,  
Emu Plains 2750, NSW, Australia  
P.O Box 487, Emu Plains 2750, NSW Australia

### CUSTOMER CARE

-  Australia: 1300 92 4632
-  New Zealand: 067 590 870
-  [customercare@infa.com.au](mailto:customercare@infa.com.au)

 [infagroup.com.au](http://infagroup.com.au)

 Infa Group

 @infagroup\_

 @infagroup



Australian  
Standard

AS/NZS: 1754:2013  
Licence No. 25324-2  
SAI Global

**ISSUE: E**

